

INCLINE VILLAGE GENERAL IMPROVEMENT DISTRICT
PONDEROSA & TUNNEL CREEK WATER MAIN
REPLACEMENT

IVGID PROJECT NUMBER 2299WS1803
PWP NO. WA-2025-053

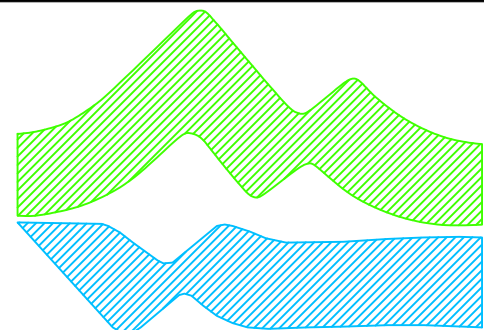

INCLINE VILLAGE
GENERAL IMPROVEMENT
DISTRICT
1220 SWEETWATER RD.
INCLINE VILLAGE, NV 89451
P: 775.832.1203

OWNER:
INCLINE VILLAGE GENERAL
IMPROVEMENT DISTRICT
1220 SWEETWATER RD.
INCLINE VILLAGE, NV 89451
PHONE: (775) 832-1203

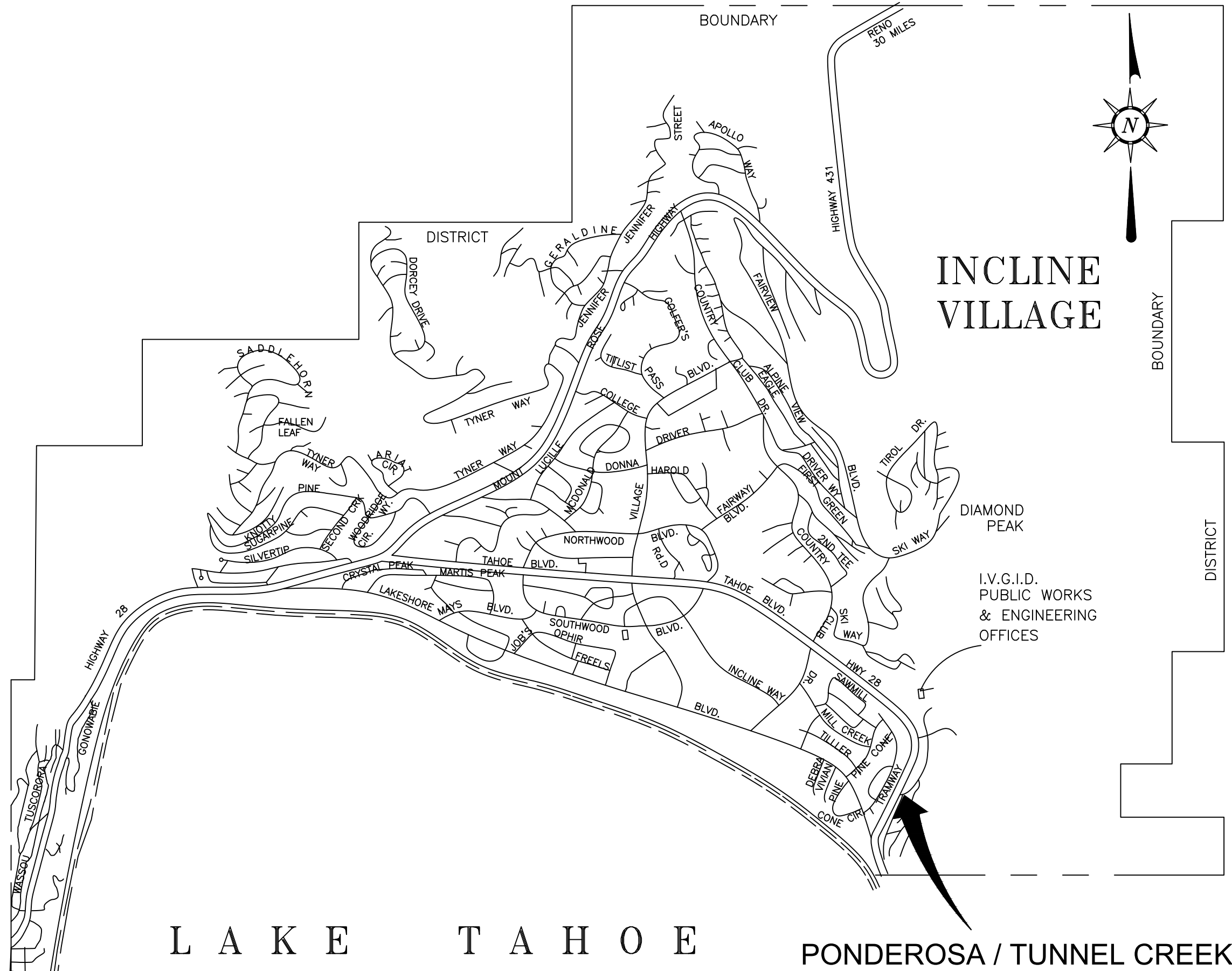

SHEET INDEX		
PAGE NUMBER	SHEET NUMBER	SHEET TITLE
1	G1.1	COVER SHEET
2	G1.2	GENERAL NOTES
3	G1.3	UTILITY NOTES
4	C1.1	PONDEROSA STA. 1+00 - 8+00
5	C1.2	PONDEROSA STA. 8+00 - 14+51
6	C2.1	TUNNEL CREEK
7	C3.1	BID ALTERNATE
8	D1.1	E.C. SHEET 1
9	D1.2	DETAIL SHEET 1
10	D1.3	DETAIL SHEET 2
11	D1.4	DETAIL SHEET 3
12	D1.5	DETAIL SHEET 4



NOTE:
THE EXISTENCE AND LOCATION OF ANY UNDERGROUND UTILITY PIPE, CONDUIT, OR STRUCTURES SHOWN ON THESE PLANS ARE OBTAINED BY A SEARCH OF THE AVAILABLE RECORDS. THE CONTRACTOR IS REQUIRED TO TAKE DUE PRECAUTIONARY MEASURES TO PROTECT THE UTILITY LINES SHOWN ON THESE DRAWINGS. THE CONTRACTOR FURTHER ASSUMES ALL LIABILITY AND RESPONSIBILITY FOR THE UTILITY PIPES, CONDUITS, AND OTHER STRUCTURES SHOWN OR NOT SHOWN ON THESE DRAWINGS.

PONDEROSA & TUNNEL CREEK WATER MAIN
REPLACEMENT

REVISION #	DATE	REVISION DESCRIPTION

PROJECT #: 2299WS1803	
DATE: 10/30/2024	
SHEET SCALE: N.T.S.	
SHEET DESCRIPTION: COVER SHEET	
SHEET #: G1.1	PAGE #: 1 OF 12

U:\Engineering\Projects\Current & Ongoing Projects\2024 2299WS\1803 Ponderosa Ranch Road Waterlines\1 - Design\XX% Designs\Drawings\01 Ponderosa WL_ General Sheets.dwg

GENERAL NOTES:

1.

ALL CONSTRUCTION AND MATERIALS SHALL CONFORM TO THE BOOK "STANDARD SPECIFICATIONS FOR PUBLIC WORKS CONSTRUCTION" (THE 2012 SSPWC REQUIREMENTS AS THEY EXISTED ON JULY 1, 2014), INCLUDING ANY ADDITIONS OR MODIFICATIONS THAT ARE SET FORTH IN THE DRAWINGS OR SPECIFICATIONS.
2.

CONTRACTOR SHALL DULY INVESTIGATE AND SATISFY THEMSELVES OF THE SUBSURFACE CONDITIONS THAT ARE PRESENT AT THE SITE.
3.

CONTRACTOR SHALL COMPLY WITH ALL APPLICABLE LAWS AND REGULATIONS RELATING TO THE SAFETY OF PERSONS OR PROPERTY, OR TO THE PROTECTION OF PERSONS OR PROPERTY FROM DAMAGE, INJURY, OR LOSS; AND SHALL ERECT AND MAINTAIN ALL NECESSARY SAFEGUARDS FOR SUCH SAFETY AND PROTECTION.
4.

CONTRACTOR TO NOT EXERCISE OR OPERATE ANY VALVES OR OTHER UTILITIES DURING THE COURSE OF CONSTRUCTION. ANY TIE-IN OR MEANS OF OPERATIONS TO ISOLATE WATERLINES TO BE COORDINATED WITH OWNER/UTILITY REPRESENTATIVE.
5.

ALL DAMAGE, INJURY, OR LOSS TO ANY PROPERTY, DIRECTLY OR INDIRECTLY, OR IN PART BY THE CONTRACTOR SHALL BE REMEDIED BY THE CONTRACTOR.
6.

IN EMERGENCIES AFFECTING THE SAFETY OR PROTECTION OF PERSONS OR THE WORK OR PROPERTY AT THE SITE OR ADJACENT THERETO, CONTRACTOR IS OBLIGATED TO ACT TO PREVENT THREATENED DAMAGE, INJURY OR LOSS.
7.

CONTRACTOR SHALL ASSUME SOLE AND COMPLETE RESPONSIBILITY FOR JOB SITE CONDITIONS DURING THE COURSE OF CONSTRUCTION FOR THIS PROJECT, INCLUDING SAFETY OF ALL PERSONS AND PROPERTY; THAT THIS REQUIREMENT SHALL APPLY CONTINUOUSLY, AND NOT BE LIMITED TO NORMAL WORKING HOURS.
8.

CONTRACTOR SHALL BE RESPONSIBLE FOR ALL EXCAVATION AND SHORING PROCEDURES AND CONFORM TO THE LATEST OSHA REQUIREMENTS.
9.

CONTRACTOR SHALL BE SOLELY RESPONSIBLE FOR INITIATING, MAINTAINING AND SUPERVISING ALL SAFETY PRECAUTIONS AND PROGRAMS IN CONNECTION WITH THE WORK.
10.

CONTRACTOR SHALL MAINTAIN AN ON-GOING DUST CONTROL PROGRAM, INCLUDING WATERING OF OPEN AREAS, IN ORDER TO CONFORM WITH THE LATEST FEDERAL, STATE, AND COUNTY AIR POLLUTION REGULATIONS.
11.

CONTRACTOR SHALL BE RESPONSIBLE FOR DAILY REMOVAL OF ALL CONSTRUCTION MATERIALS SPILLED ON PAVED STREETS, ON-SITE OR OFF-SITE. AT THE CLOSE OF EACH DAY, THE CONTRACTOR SHALL INSPECT THE SITE FOR ANY ACCUMULATIONS OF WASTE MATERIALS, RUBBISH, AND OTHER DEBRIS AND PROPERLY DISPOSE OF IT IN ACCORDANCE WITH APPLICABLE LAWS AND REGULATIONS.
12.

IF WATER IS ENCOUNTERED IN THE PERFORMANCE OF THE WORK, CONTRACTOR SHALL FURNISH, INSTALL, MAINTAIN AND OPERATE ALL THE NECESSARY MACHINERY, APPLIANCES, AND EQUIPMENT TO KEEP THE EXCAVATIONS CLEAR AND FREE FROM WATER UNTIL THE WORK IS COMPLETED, INSPECTED AND APPROVED AND ALL DANGER OF FLOTATION AND OTHER DAMAGES ARE REMOVED. IF WATER IS ENCOUNTERED NOTIFY ENGINEER FOR ANY MODIFICATIONS THAT MAY BE REQUIRED TO PREVENT FLOTATION.
13.

WATER PUMPED FROM THE DEWATERING OPERATIONS SHALL BE LEGALLY DISPOSED OF IN SUCH A MANNER AS WILL NOT CAUSE INJURY TO THE ENVIRONMENT, PUBLIC OR PRIVATE PROPERTY, OR CONSTITUTE A NUISANCE OR MENACE TO THE PUBLIC. CONTRACTOR IS RESPONSIBLE FOR OBTAINING DISCHARGE PERMITS IF THE CONTRACTOR DESIRES TO DISCHARGE TO A SURFACE DRAIN.
14.

CONTRACTOR SHALL NOTIFY THE OWNER, ALL GOVERNING AGENCIES HAVING JURISDICTION OVER THE WORK, UTILITY COMPANIES, TELEPHONE COMPANIES, CABLE TELEVISION COMPANIES, AND ANY OTHER ENTITY IMPACTED BY THE WORK 48 HOURS PRIOR TO BEGINNING CONSTRUCTION. CONTRACTOR SHALL GIVE 24 HOURS PRIOR NOTICE FOR ALL CONSTRUCTION STAKING AND INSPECTIONS REQUIRED DURING CONSTRUCTION.
15.

CONTRACTOR IS HEREBY NOTIFIED THAT PRIOR TO COMMENCING CONSTRUCTION, HE IS RESPONSIBLE FOR CONTACTING ALL UTILITY COMPANIES FOR VERIFICATION AT THE CONSTRUCTION SITE OF THE LOCATIONS OF ALL UNDERGROUND FACILITIES WHERE SUCH FACILITIES MAY POSSIBLY CONFLICT WITH THE PLACEMENT OF THE IMPROVEMENTS SHOWN ON THE PLANS. CALL "UNDERGROUND SERVICE ALERT" AT 800-227-2600 TWO (2) DAYS MINIMUM TO FOURTEEN (14) DAYS MAXIMUM BEFORE ANY EXCAVATION IS STARTED.
16.

ALL AREAS DISTURBED AND LEFT UNDEVELOPED FOR A PERIOD OF MORE THAN 30 DAYS SHALL BE STABILIZED BY THE APPLICATION OF AN APPROVED DUST PALLIATIVE AT NO EXPENSE TO THE OWNER.
17.

INSTALLATION AND MAINTENANCE OF EROSION CONTROL MEASURES ARE THE RESPONSIBILITY OF THE CONTRACTOR AND SHALL BE PER THE APPROVED STORM WATER POLLUTION PREVENTION PLAN KEPT ON-SITE. THE CONTRACTOR SHALL BE RESPONSIBLE FOR THE PREVENTION OF SIGNIFICANT EROSION AND SILTATION ENTERING THE STORM DRAIN SYSTEM, NATURAL DRAINAGE COURSES AND/OR INTRUDING UPON ADJACENT ROADWAYS AND PROPERTIES.
18.

CONTRACTOR SHALL OBTAIN AND PAY FOR ALL NECESSARY PERMITS AND FEES REQUIRED FOR CONSTRUCTION.
19.

IF DURING PERFORMANCE OF THE WORK, CONTRACTOR DISCOVERS ANY CONFLICT, ERROR, AMBIGUITY OR DISCREPANCY WITHIN THE CONSTRUCTION DRAWINGS OR BETWEEN THE CONSTRUCTION DRAWINGS AND ANY PROVISION OF ANY LAW OR REGULATION APPLICABLE TO THE PERFORMANCE OF THE WORK, CONTRACTOR SHALL REPORT TO THE ENGINEER IN WRITING AT ONCE.
20.

IF AN UNDERGROUND FACILITY IS UNCOVERED OR REVEALED AT OR CONTIGUOUS TO THE SITE WHICH WAS NOT SHOWN OR INDICATED WITH REASONABLE ACCURACY IN THE CONSTRUCTION DRAWINGS, THE CONTRACTOR SHALL, PROMPTLY AFTER BECOMING AWARE THEREOF AND BEFORE DISTURBING CONDITIONS AFFECTED THEREBY OR PERFORMING ANY WORK IN CONNECTION THEREWITH (EXCEPT IN AN EMERGENCY) IDENTIFY THE OWNER OF THE UNDERGROUND UTILITY FACILITY AND GIVE WRITTEN NOTICE TO THE OWNER OF THE UNDERGROUND FACILITY, THE OWNER AND THE ENGINEER. THE ENGINEER WILL PROMPTLY REVIEW THE UNDERGROUND FACILITY AND DETERMINE THE EXTENT, IF ANY, TO WHICH A CHANGE IN THE CONSTRUCTION DRAWINGS IS NECESSARY.
21.

CONTRACTOR SHALL BE RESPONSIBLE FOR ALL CONSTRUCTION SIGNING, BARRICADES, AND TRAFFIC DELINEATION TO CONFORM TO THE STATE OF NEVADA, DEPARTMENT OF TRANSPORTATION "NEVADA WORK ZONE TRAFFIC CONTROL MANUAL" AND CHAPTER 6 OF THE MANUAL ON UNIFORM TRAFFIC CONTROL DEVICES (LATEST EDITION).
22.

ANY EXCAVATION BY CONTRACTOR THAT UNCOVERS A HISTORICAL OR ARCHAEOLOGICAL ARTIFACT SHALL BE ADDRESSED IN ACCORDANCE WITH THE ENVIRONMENTAL PROTECTION SPECIFICATION SECTION 01140 CONTAINED IN THE TECHNICAL SPECIFICATIONS.
23.

CONTRACTOR SHALL PROTECT FROM DAMAGE EXISTING UTILITY STRUCTURES ON AND AROUND THE SITE INCLUDING, BUT NOT LIMITED TO , PAVEMENT, CURB AND GUTTER, SIDEWALK, LANDSCAPING, SIGNAGE, STORM AND SANITARY SEWERS, UTILITIES, TELEPHONE, AND CABLE TELEVISION. THE CONTRACTOR SHALL ASSUME SOLE RESPONSIBILITY FOR THE REPAIR AND/OR REPLACEMENT OF ANY IMPROVEMENTS (NEW OR EXISTING) DAMAGED THROUGHOUT THE COURSE OF CONSTRUCTION EITHER AS A DIRECT RESULT OF THE ACTIVITIES OR THE FAILURE TO ADEQUATELY PROTECT THE IMPROVEMENT. CONTRACTOR SHALL BE RESPONSIBLE FOR THE REPAIR OF ANY DAMAGED PRIVATE PROPERTY INCLUDING BUT NOT LIMITED TO EXISTING FENCING AND LANDSCAPING.
24.

CONTRACTOR SHALL NOTIFY OWNERS OF ADJACENT PROPERTY AND UNDERGROUND FACILITIES AND OTHER UTILITY OWNERS WHEN EXECUTION OF THE WORK MAY AFFECT THEM, AND SHALL COOPERATE WITH THEM IN THE PROTECTION, REMOVAL, RELOCATION, AND REPLACEMENT OF THEIR PROPERTY.
25.

CONTRACTOR SHALL, DURING THE COURSE OF THE PROJECT, MAINTAIN RECORD DRAWINGS INDICATING BY DIMENSION AND DESCRIPTION ANY FACILITY CONSTRUCTED CONTRARY TO THAT SHOWN ON THE DRAWINGS OR DESCRIBED IN THE SPECIFICATIONS. AT THE END OF CONSTRUCTION, THE RECORD DRAWINGS SHALL BE TURNED OVER TO THE ENGINEER.
26.

PRIOR TO THEIR INCORPORATION INTO THE WORK, CONTRACTOR SHALL SUBMIT FOR THE ENGINEER'S APPROVAL SHOP DRAWINGS AND MATERIAL SPECIFICATIONS FOR ALL MATERIALS TO BE USED ON THE PROJECT. ANY WORK PERFORMED PRIOR TO THE ENGINEER'S REVIEW AND APPROVAL OF THE SHOP DRAWINGS WILL BE AT THE SOLE EXPENSE AND RESPONSIBILITY OF THE CONTRACTOR.
27.

CONTRACTOR SHALL AT ALL TIMES PROVIDE AND MAINTAIN EMERGENCY ACCESS THROUGH THE PROJECT SITE IN ACCORDANCE WITH THE REQUIREMENTS OF THE PUBLIC PROTECTION AGENCIES HAVING JURISDICTION OVER THE PROJECT SITE WHICH SHALL INCLUDE POLICE, SHERIFF, FIRE, AMBULANCE, WASHOE COUNTY SCHOOL DISTRICT AND WASTE MANAGEMENT OF ANY POTENTIAL DELAYS/CLOSURES. THE CONTRACTOR SHALL ALSO COORDINATE WITH THE SAME AGENCIES ANY REQUIRED STREET CLOSURES AND/OR DETOURS.
28.

TIES TO EXISTING FACILITIES MUST HAVE PRIOR APPROVAL OF THE INSPECTOR OR OWNER.
29.

CONTRACTOR SHALL COORDINATE ALL CONSTRUCTION ACTIVITIES, INCLUDING UTILITIES AND EQUIPMENT, TO ELIMINATE CONFLICTS BETWEEN THE ACTIVITIES OF ALL SUBCONTRACTORS AND OTHER UTILITY COMPANIES WHICH MAY ALSO BE WORKING IN THE SAME AREA.
30.

ABANDONED UTILITIES AND STRUCTURES, WHEN ENCOUNTERED, SHALL BE REMOVED AND LEGALLY DISPOSED OF BY THE CONTRACTOR. CONFLICTS WITH OTHER EXISTING ABANDONED UTILITIES AND STRUCTURES ARE ANTICIPATED. THE CONTRACTOR WILL NOT BE PAID DIRECTLY FOR THE REMOVAL AND DISPOSAL OF THESE MATERIALS BUT MUST INCLUDE THE COST FOR THIS WORK IN THE BID ITEMS.
31.

ALL ABANDONED PIPE (IF OPEN OR CUT) ENDS SHALL BE PLUGGED WITH A MINIMUM 2 FOOT CONCRETE PLUG.
32.

CONTRACTOR IS RESPONSIBLE FOR THE PROTECTION OF ALL EXISTING MONUMENTS AND OTHER SURVEY MARKERS. MONUMENTS AND SURVEY MARKERS DESTROYED DURING CONSTRUCTION SHALL BE REPLACED AT THE CONTRACTOR'S EXPENSE.
33.

PROPERTY AND RIGHT-OF-WAY LINES AS SHOWN ARE APPROXIMATE ONLY AND SHOULD NOT BE USED TO SCALE FROM, BUT ARE SHOWN FOR REFERENCE ONLY.
34.

ANY HAZARDOUS OR TOXIC WASTE OR HAZARDOUS ENVIRONMENTAL CONDITION ENCOUNTERED AT THE SITE OR CREATED BY CONTRACTOR THROUGHOUT THE COURSE OF THE WORK SHALL BE ADDRESSED IN ACCORDANCE WITH SECTION 5.06 OF THE GENERAL CONDITIONS.
35.

CONTRACT DOCUMENTS ARE COMPLEMENTARY, WHAT IS REQUIRED BY ONE IS REQUIRED BY ALL.
36.

ANY AND ALL WORK ON PONDEROSA RANCH ROAD IS REQUIRED TO BE COORDINATED WITH IVGID AND PROPERTY OWNERS TO GAIN ACCESS TO THE CONSTRUCTION AREA. CONTRACTOR TO ACCOMMODATE ANY REASONABLE REQUEST BY PROPERTY OWNER TO ALLOW ACCESS THROUGH CONSTRUCTION SITE.

PROJECT SHEET INDEX



NOTE:
THE EXISTENCE AND LOCATION OF ANY UNDERGROUND UTILITY PIPE, CONDUIT, OR STRUCTURES SHOWN ON THESE PLANS ARE OBTAINED BY A SEARCH OF THE AVAILABLE RECORDS. THE CONTRACTOR IS REQUIRED TO TAKE DUE PRECAUTIONARY MEASURES TO PROTECT THE UTILITY LINES SHOWN ON THESE DRAWINGS. THE CONTRACTOR FURTHER ASSUMES ALL LIABILITY AND RESPONSIBILITY FOR THE UTILITY PIPES, CONDUITS, AND OTHER STRUCTURES SHOWN OR NOT SHOWN ON THESE DRAWINGS.

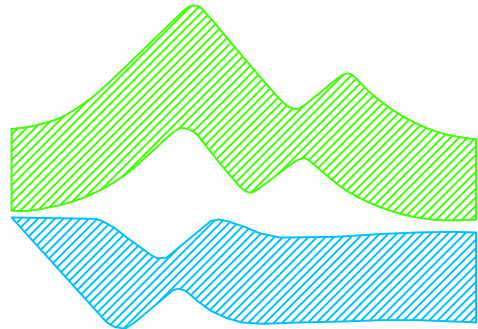

INCLINE VILLAGE
GENERAL IMPROVEMENT
DISTRICT

1220 SWEETWATER RD.
INCLINE VILLAGE, NV 89451
P: 775.832.1203

PONDEROSA & TUNNEL CREEK WATER MAIN
REPLACEMENT

REVISION # DATE REVISION DESCRIPTION

PROJECT #:

2299WS1803

DATE:

10/30/2024

SHEET SCALE:

N.A.

SHEET DESCRIPTION:

GENERAL NOTES

SHEET #:

G1.2

PAGE #:

2 OF 12

U:\Engineering\Projects\Current & Ongoing Projects\2024 2299WS1803 Ponderosa Ranch Road Waterlines\1 - Design\XX%\ Designs\Drawings\01 Ponderosa WL_ General Sheets.dwg



NOTE:
THE EXISTENCE AND LOCATION OF ANY UNDERGROUND UTILITY PIPE, CONDUIT, OR STRUCTURES SHOWN ON THESE PLANS ARE OBTAINED BY A SEARCH OF THE AVAILABLE RECORDS. THE CONTRACTOR IS REQUIRED TO TAKE DUE PRECAUTIONARY MEASURES TO PROTECT THE UTILITY LINES SHOWN ON THESE DRAWINGS. THE CONTRACTOR FURTHER ASSUMES ALL LIABILITY AND RESPONSIBILITY FOR THE UTILITY PIPES, CONDUITS, AND OTHER STRUCTURES SHOWN OR NOT SHOWN ON THESE DRAWINGS.

UTILITY GENERAL NOTES:

1. LOCATIONS OF EXISTING UTILITIES ARE APPROXIMATE AND DEPTHS ARE UNKNOWN. CONTRACTOR IS RESPONSIBLE FOR EXACT FIELD LOCATIONS.
2. PROVIDE 12 INCHES MINIMUM VERTICAL CLEARANCE BETWEEN EXISTING UTILITIES, UNLESS OTHERWISE NOTED OR APPROVED.
3. THE CONTRACTOR SHALL COORDINATE UNDERGROUND CONSTRUCTION IN SUCH A MANNER AS TO PREVENT ANY CONFLICT WHERE UTILITY LINES CROSS.
4. RELOCATION OF EXISTING UTILITIES SHALL BE DONE UNDER THE DIRECTION OF THE UTILITY HAVING JURISDICTION OVER THE UTILITY IN QUESTION.
5. IF ANY UNKNOWN SUBSURFACE STRUCTURES ARE ENCOUNTERED DURING THE COURSE OF CONSTRUCTION, THEY SHALL BE BROUGHT TO THE ATTENTION OF THE DISTRICT PRIOR TO PROCEEDING.
6. WATER AND/OR SEWER SERVICE SHALL NOT BE INTERRUPTED DURING CONSTRUCTION WITHOUT PRIOR APPROVAL BY THE DISTRICT. THE CONTRACTOR SHALL TAKE ADEQUATE MEASURES TO ENSURE CONTINUOUS OPERATION OF THE SEWER AND WATER FACILITIES OUTSIDE OF PLANNED AND SCHEDULED SYSTEM SHUTDOWNS.
7. ALL COMPONENTS AND MATERIALS IN CONTACT WITH THE WATER SYSTEM SHALL BE ANSI/NSF 61 CERTIFIED.
8. WATER MAIN SHALL BE DISINFECTED AND SAMPLED IN ACCORDANCE WITH AWWA C651. DISPOSAL OF THE CHLORINATED WATER MUST BE COORDINATED WITH THE BUREAU OF WATER POLLUTION CONTROL. (NAC 455a.67145.6.A). SEE SECTION 02510-DISINFECTION OF WATER DISTRIBUTION FOR MORE DETAILS.
9. ANY OPENINGS IN UNFINISHED PIPING AND APPURTENANCES MUST BE SEALED AT THE END OF EACH WORKING DAY IN SUCH A MANNER AS TO PREVENT THE ENTRY OF BIRDS AND OTHER ANIMALS, DIRT, TRENCH WATER AND OTHER SOURCES OF POLLUTION OR CONTAMINATION. (NAC 445A.67145.8).
10. C900 PVC MAINS SHALL BE PRESSURE TESTED IN ACCORDANCE WITH AWWA C605. (NAC 445A.67145.8). SEE SECTION 02510-WATER DISTRIBUTION FOR MORE DETAILS.
11. ANY LATERAL THAT CANNOT BE PRESSURE TESTED AT THE SAME TIME AS THE MAIN SHALL REMAIN UN-BURIED TO ALLOW FOR VISUAL INSPECTION DURING COMMISSIONING OF THE WATER MAIN.
12. CONTRACTOR TO COORDINATE WITH IVGID A PLAN AND SCHEDULE TO TIE-IN ALL LATERALS AND HYDRANTS.

STAGING NOTES:

1. CONTRACTOR TO COORDINATE STAGING AREA WITH IVGID AND PRIVATE PROPERTY OWNERS.
2. APPROVAL TO STAGE EQUIPMENT AND MATERIALS ON PONDEROSA RANCH RD. WILL BE REQUIRED TO BE OBTAINED FROM THE PRIVATE PROPERTY OWNERS.
3. APPROVAL TO STAGE EQUIPMENT AND MATERIALS ALONG TUNNEL CREEK RD. WILL BE REQUIRED TO BE OBTAINED FROM WASHOE COUNTY.
4. STAGING AREA SHALL HAVE CONSTRUCTION FENCING AND PROPER SIGNAGE TO PREVENT PUBLIC ACCESS TO THE AREA.
5. STAGING AREA SHALL BE RESTORED TO ORIGINAL CONDITION AT THE COMPLETION OF CONSTRUCTION.

LEGEND:

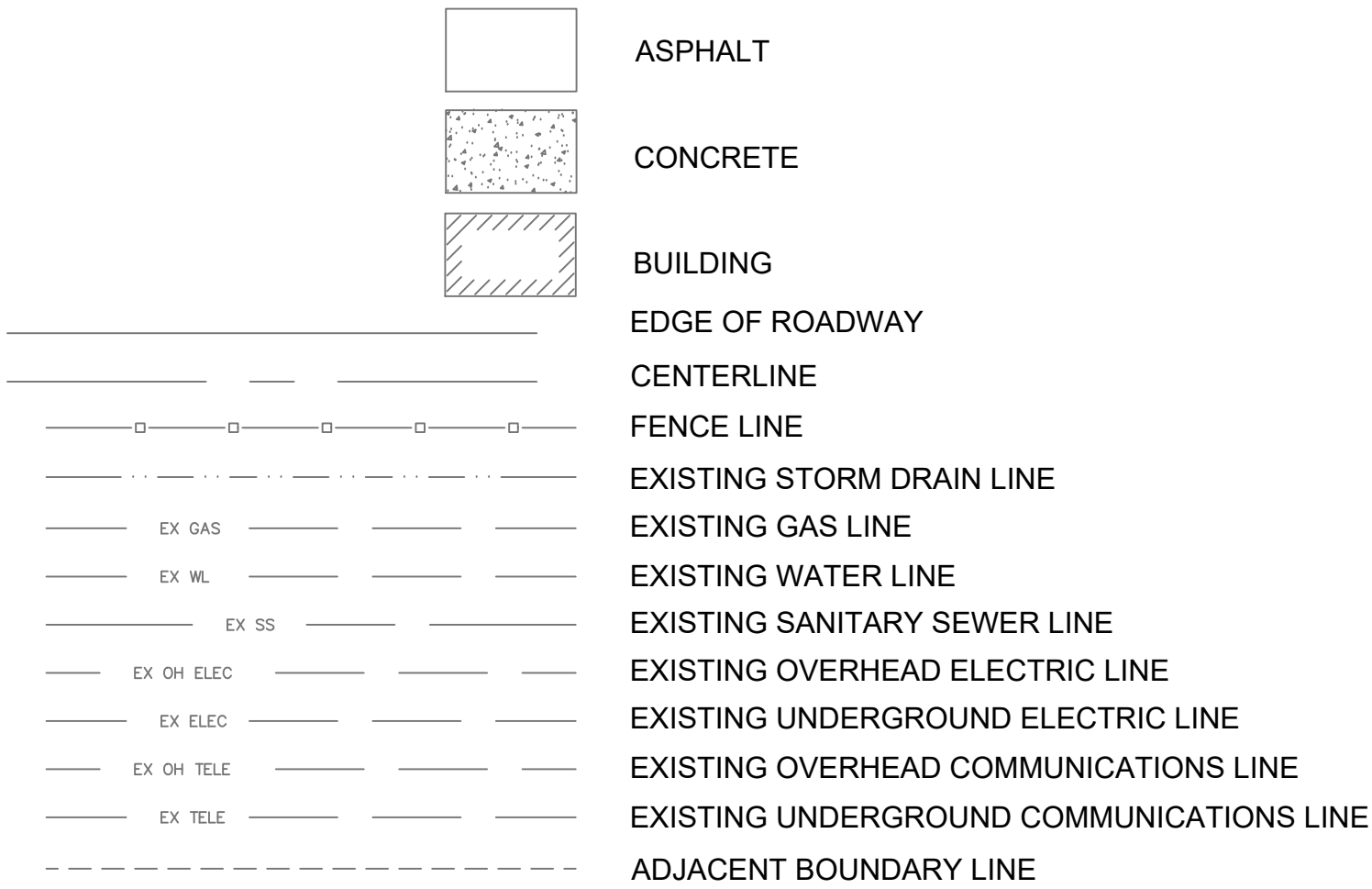

- SSCO SANITARY SEWER MANHOLE
- SDCO SANITARY SEWER CLEANOUT
- SDM STORM DRAIN CLEANOUT
- SDMI STORM DRAIN MANHOLE
- SDMD STORM DRAIN DROP INLET
- CMR CORREGATED METAL PIPE
- WV SIGN
- WB WATER BOX
- FD FIRE HYDRANT
- WM WATER METER
- WV WATER VALVE
- WVDC IRRIGATION CONTROL VALVE
- WVLT WATER VAULT
- GR GAS RISER
- GM GAS METER
- GV GAS VALVE
- GM GAS MANHOLE
- GVLT GAS VAULT
- UK UNKNOWN UTILITY
- BOLLARD
- UTILITY POLE
- GUY WIRE
- ELECTRIC BOX
- TELEPHONE BOX
- ELECTRIC VAULT
- TREE
- EXISTING METER

BASIS OF BEARINGS:

THE BASIS OF BEARING FOR THIS SURVEY IS BASED ON THE NEVADA STATE PLANE COORDINATE SYSTEM OF 1983, WEST ZONE, NAD 83 / 84, DISTANCES SHOWN ARE GROUND DISTANCES USING A PROJECT COMBINED GRID TO GROUND SCALE FACTOR OF 1.00218.

BASIS OF ELEVATIONS:

BASED ON NORTH AMERICAN VERTICAL DATUM OF NDOT MONUMENT NO. 925019 WITH A PUBLISHED ELEVATION OF 6356.05 1998 (NAVD 88) USING FT.

NOTES:

1. EASEMENTS MAY EXIST THAT ARE NOT SHOWN HEREON.
2. UTILITY INFORMATION SHOWN IS BASED ON OBSERVABLE EVIDENCE AND IS RECOMMENDED THAT UTILITY LOCATES AS REQUESTED BEFORE CONSTRUCTION.
3. SURVEY WAS CONDUCTED ON December 12, 2023.
4. BOUNDARY IS PROVIDED PER RECORD INFORMATION NO FIELD WORK WAS CONDUCTED.

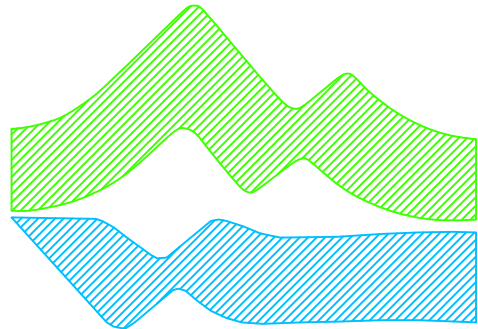

INCLINE VILLAGE
GENERAL IMPROVEMENT
DISTRICT

1220 SWEETWATER RD.
INCLINE VILLAGE, NV 89451
P: 775.832.1203

PONDEROSA & TUNNEL CREEK WATER MAIN
REPLACEMENT

REVISION # DATE REVISION DESCRIPTION

PROJECT #:

2299WS1803

DATE:

10/30/2024

SHEET SCALE:

N.T.S

SHEET DESCRIPTION:

UTILITY NOTES

SHEET #:

G1.3

PAGE #:

3 of 12

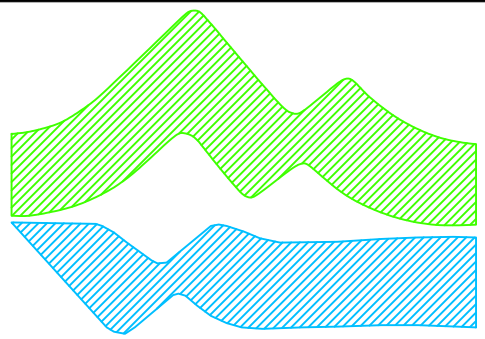

INCLINE VILLAGE
GENERAL IMPROVEMENT
DISTRICT

1220 SWEETWATER RD.
INCLINE VILLAGE, NV 89451
P: 775.832.1203

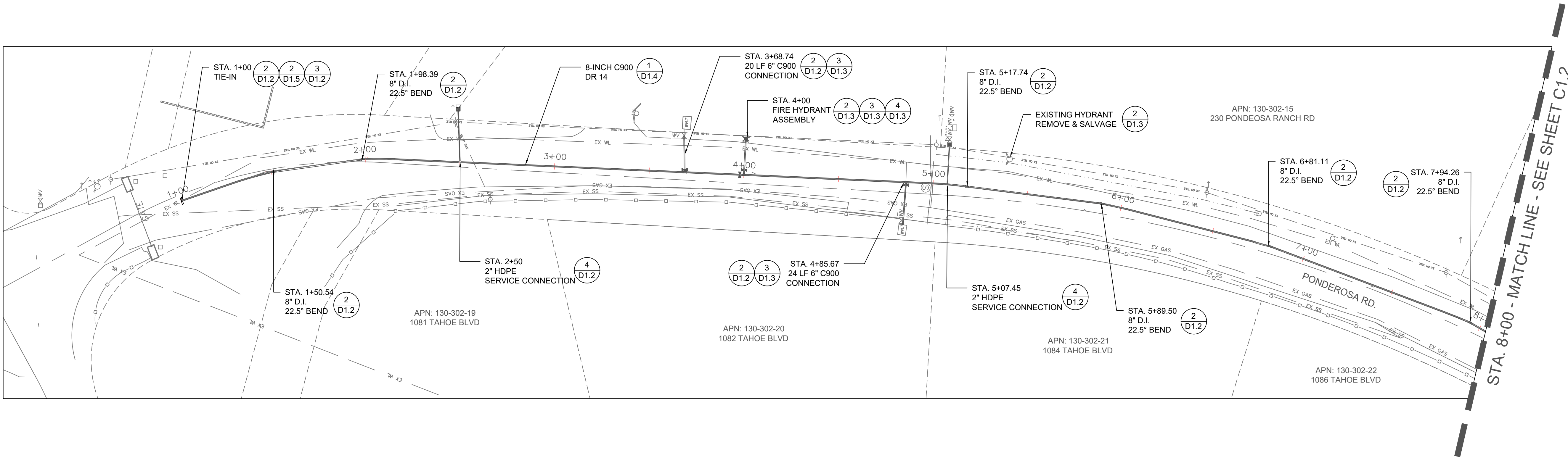

BASE BID - 8" WATERLINE - PONDEROSA RD.

SCALE: 1"=30' (AS DISPLAYED)

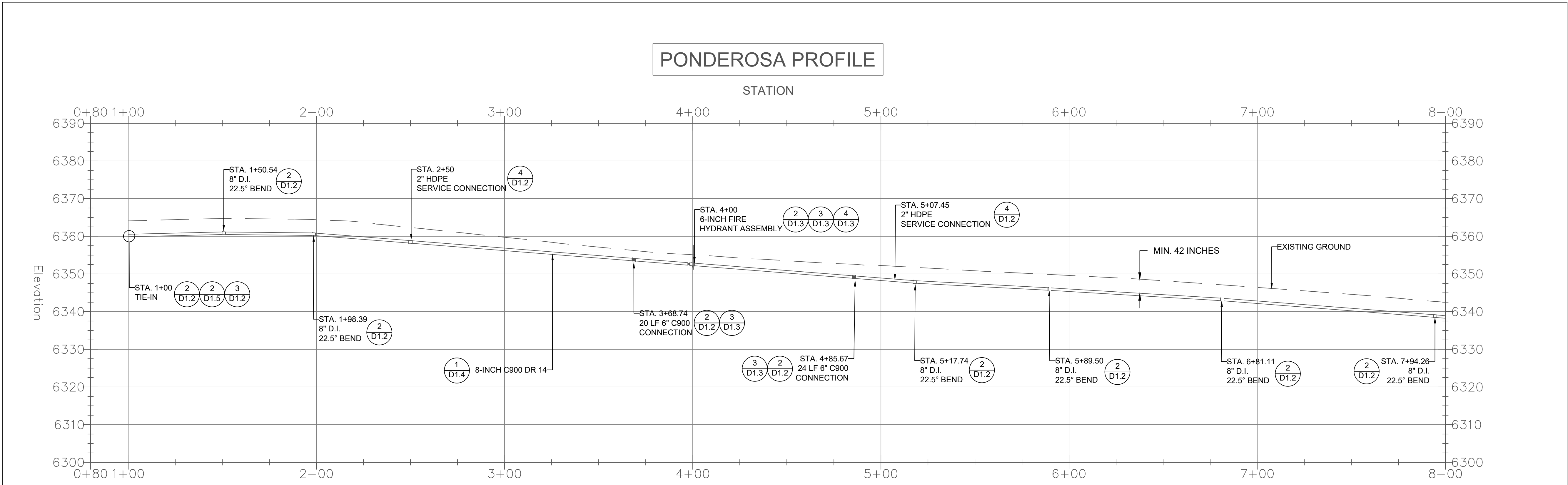
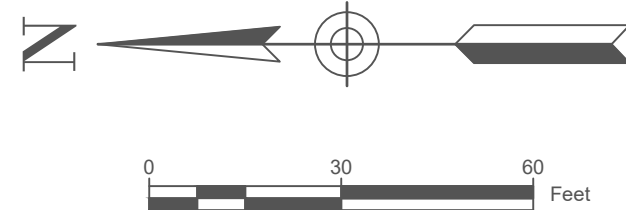

NOTE:
THE EXISTENCE AND LOCATION OF ANY UNDERGROUND UTILITY PIPE, CONDUIT, OR
STRUCTURES SHOWN ON THESE PLANS ARE OBTAINED BY A SEARCH OF THE AVAILABLE
RECORDS. THE CONTRACTOR IS REQUIRED TO TAKE DUE PRECAUTIONARY MEASURES TO
PROTECT THE UTILITY LINES SHOWN ON THESE DRAWINGS. THE CONTRACTOR FURTHER
ASSUMES ALL LIABILITY AND RESPONSIBILITY FOR THE UTILITY PIPES, CONDUITS, AND OTHER
STRUCTURES SHOWN OR NOT SHOWN ON THESE DRAWINGS.



PONDEROSA & TUNNEL CREEK WATER MAIN REPLACEMENT

REVISION # DATE REVISION DESCRIPTION

REVISION #

DATE

REVISION DESCRIPTION

PROJECT #:

2299WS1803

DATE:

10/3/2024

SHEET SCALE:

1:30

SHEET DESCRIPTION:

STA 1+00 - 8+00

SHEET #:

C1.1

PAGE #:

4 OF 12

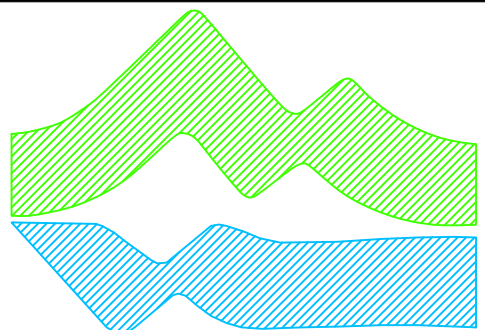

INCLINE VILLAGE
GENERAL IMPROVEMENT
DISTRICT
1220 SWEETWATER RD.
INCLINE VILLAGE, NV 89451
P: 775.832.1203

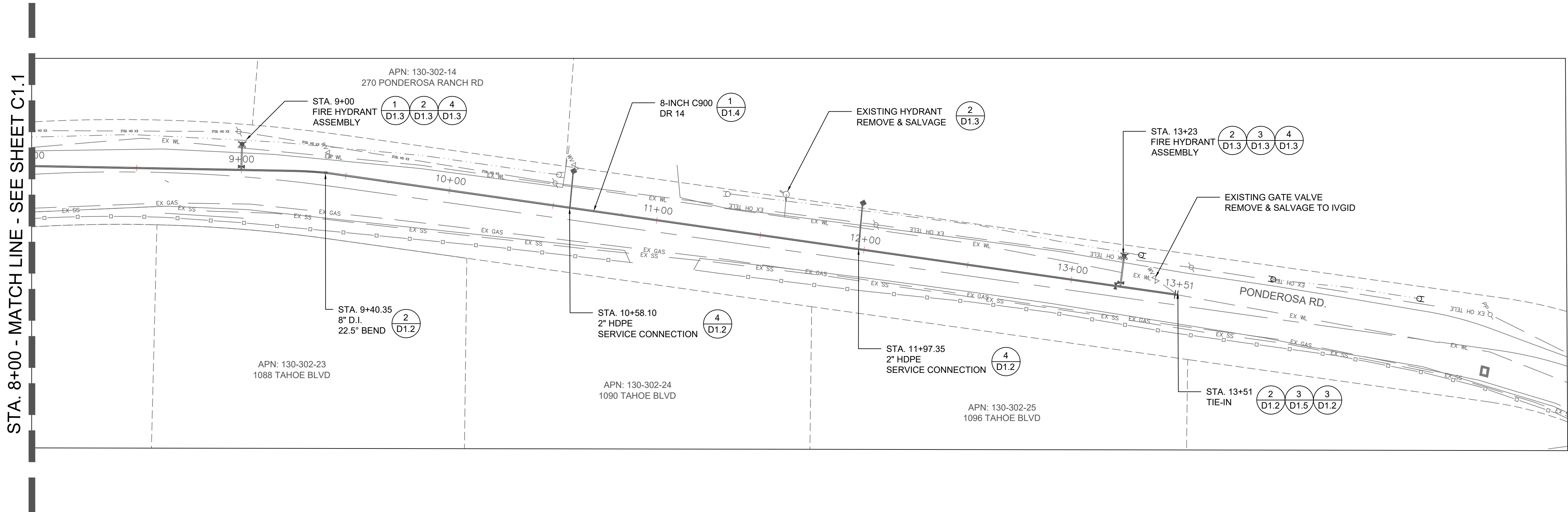

BASE BID - 8" WATERLINE - PONDEROSA RD.

SCALE: 1"=30' (AS DISPLAYED)

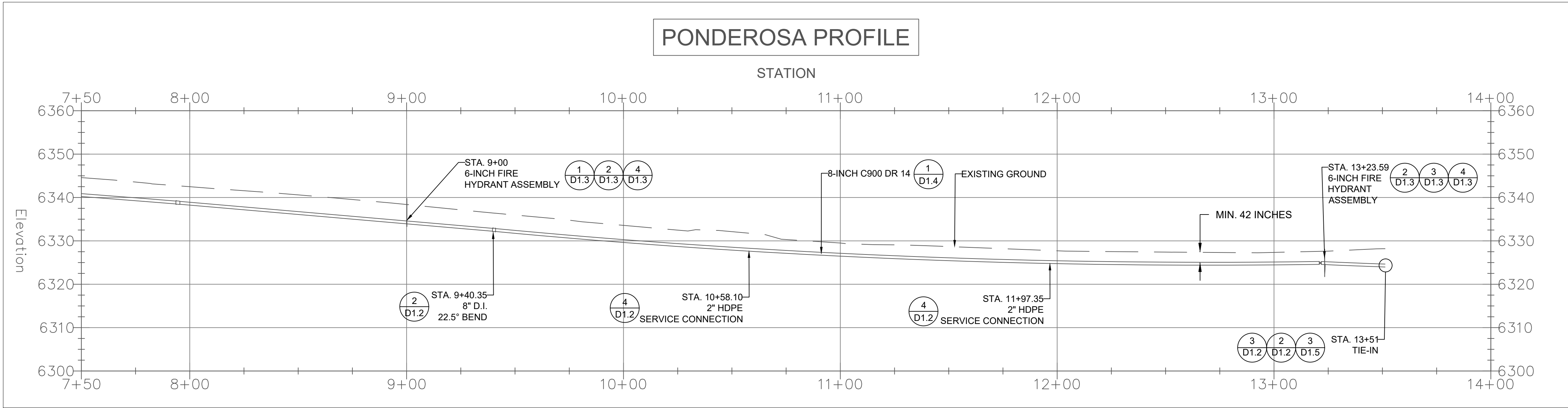
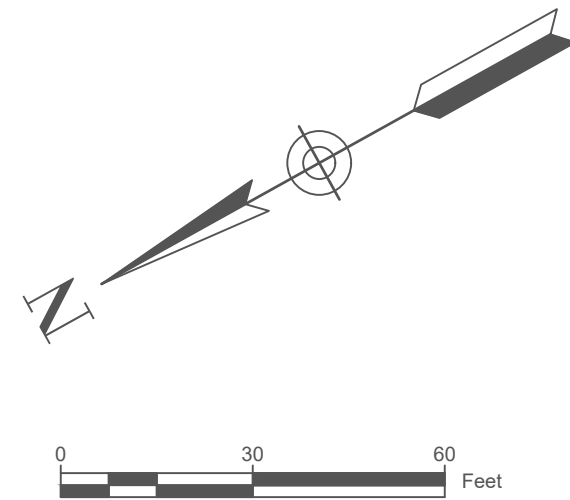

NOTE:
THE EXISTENCE AND LOCATION OF ANY UNDERGROUND UTILITY PIPE, CONDUIT, OR STRUCTURES SHOWN ON THESE PLANS ARE OBTAINED BY A SEARCH OF THE AVAILABLE RECORDS. THE CONTRACTOR IS REQUIRED TO TAKE DUE PRECAUTIONARY MEASURES TO PROTECT THE UTILITY LINES SHOWN ON THESE DRAWINGS. THE CONTRACTOR FURTHER ASSUMES ALL LIABILITY AND RESPONSIBILITY FOR THE UTILITY PIPES, CONDUITS, AND OTHER STRUCTURES SHOWN OR NOT SHOWN ON THESE DRAWINGS.

PONDEROSA & TUNNEL CREEK WATER MAIN REPLACEMENT

REVISION #	DATE	REVISION DESCRIPTION

PROJECT #:
2299WS1803

DATE:
10/3/2024

SHEET SCALE:
1:30

SHEET DESCRIPTION:
STA 8+00 - 13+51

SHEET #:
C1.2

PAGE #:
5 OF 12

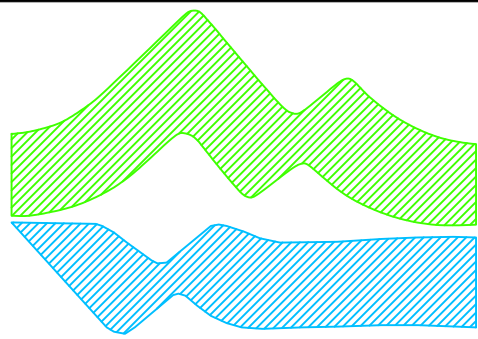

INCLINE VILLAGE
GENERAL IMPROVEMENT
DISTRICT

1220 SWEETWATER RD.
INCLINE VILLAGE, NV 89451
P: 775.832.1203

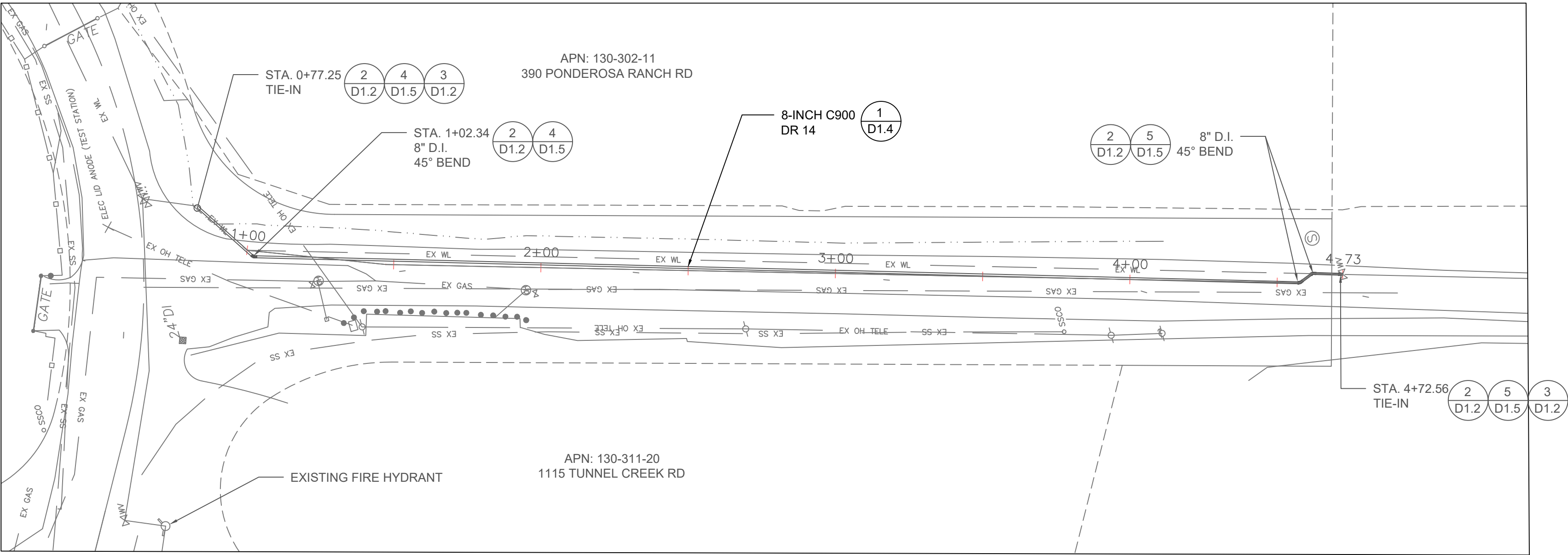

BID ALTERNATE #1 - 8" WATERLINE - TUNNEL CREEK RD.

SCALE: 1"=30' (AS DISPLAYED)

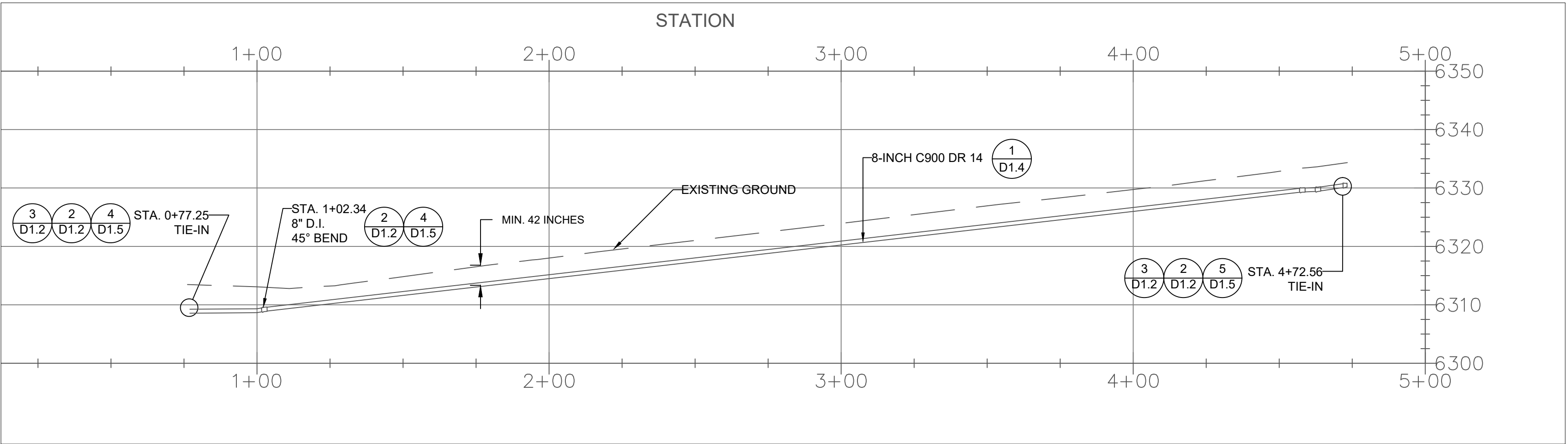
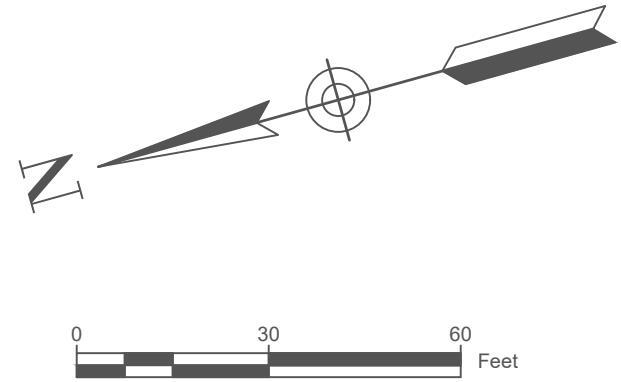

NOTE:
THE EXISTENCE AND LOCATION OF ANY UNDERGROUND UTILITY PIPE, CONDUIT, OR STRUCTURES SHOWN ON THESE PLANS ARE OBTAINED BY A SEARCH OF THE AVAILABLE RECORDS. THE CONTRACTOR IS REQUIRED TO TAKE DUE PRECAUTIONARY MEASURES TO PROTECT THE UTILITY LINES SHOWN ON THESE DRAWINGS. THE CONTRACTOR FURTHER ASSUMES ALL LIABILITY AND RESPONSIBILITY FOR THE UTILITY PIPES, CONDUITS, AND OTHER STRUCTURES SHOWN OR NOT SHOWN ON THESE DRAWINGS.

PONDEROSA & TUNNEL CREEK WATER MAIN REPLACEMENT

REVISION #	DATE	REVISION DESCRIPTION

PROJECT #:

2299WS1803

DATE:

10/3/2024

SHEET SCALE:

1:30

SHEET DESCRIPTION:

STA 1+00 - 4+57

SHEET #:

C2.1

PAGE #:

6 OF 12

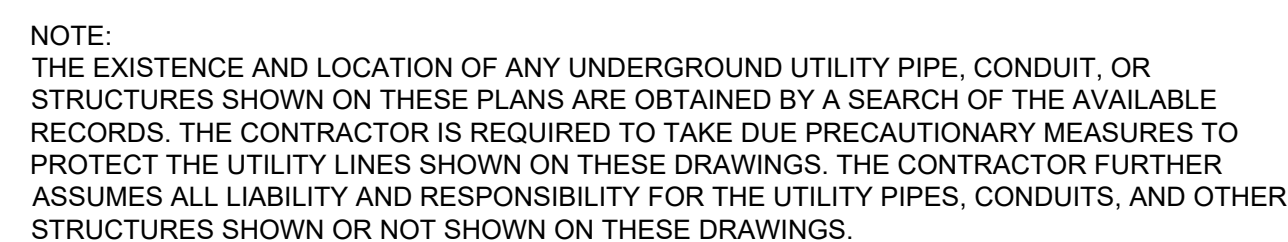
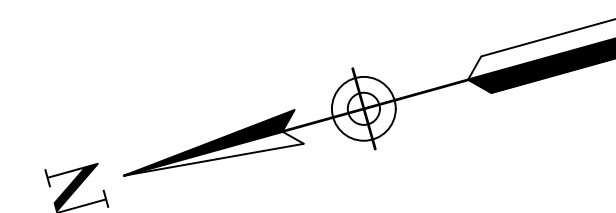
7 OF 12

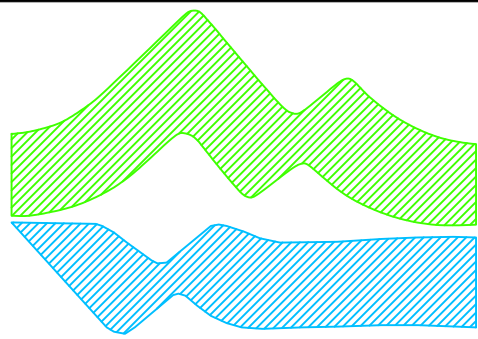

INCLINE VILLAGE
GENERAL IMPROVEMENT
DISTRICT

1220 SWEETWATER RD.
INCLINE VILLAGE, NV 89451
P: 775.832.1203

PONDEROSA & TUNNEL CREEK WATER MAIN
REPLACEMENT

REVISION #	DATE	REVISION DESCRIPTION

PROJECT #:
2299WS1803

DATE:
10/3/2024

SHEET SCALE:
N.T.S

SHEET DESCRIPTION:
EROSION CONTROL

SHEET #: D1.1	PAGE #: 8 OF 12
------------------	--------------------

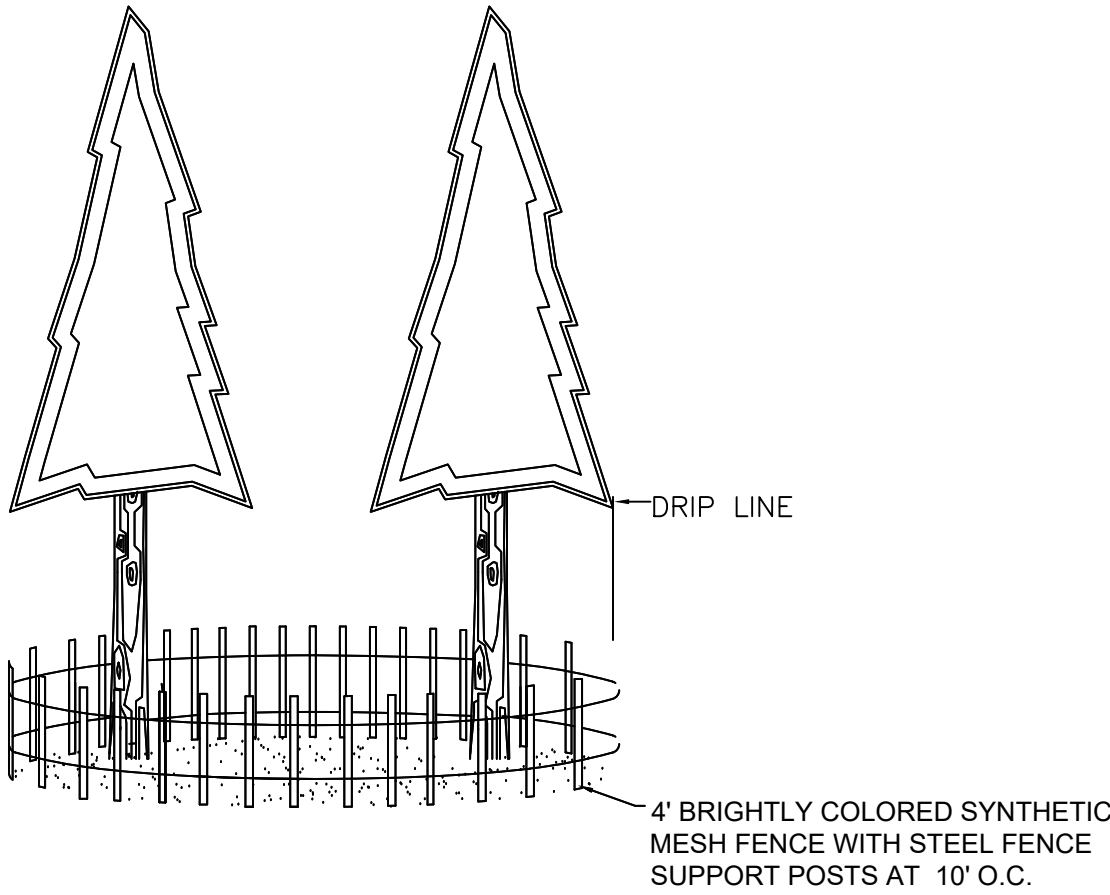

NOTE:
1. FOR USE IN OTHER AREAS, PLACE FENCING AT LIMIT OF AREA TO BE DISTURBED.

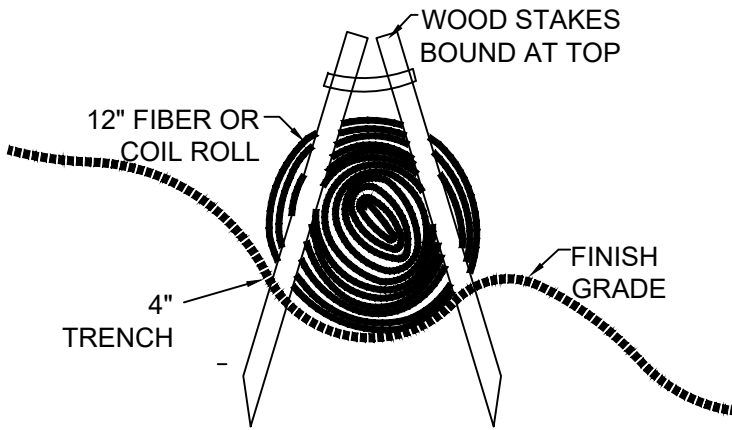
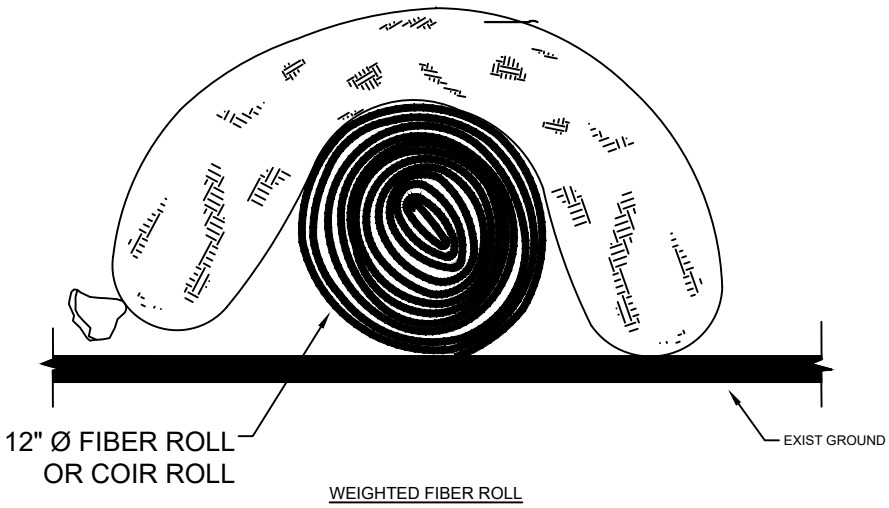

NOTE: PLACE FIBER ROLLS ALONG CONTOUR.

EROSION CONTROL NOTES:

1. IN THE EVENT OF GROUND OR SURFACE WATER IS INTERCEPTED DURING EXCAVATIONS THE CONTRACTOR SHALL SUBMIT A DEWATERING PLAN TO IVGID FOR REVIEW AND APPROVAL BY TRPA. NO EXCAVATIONS SHALL OCCUR UNTIL TRPA HAS REVIEWED AND APPROVED THE DEWATERING PLAN.
2. DUST CONTROL PRACTICES ARE REQUIRED FOR ANY GRADING ACTIVITY AND ARE APPLICABLE TO MOST CONSTRUCTION SITES. ALL EXPOSED AREAS OF THE APPROVED CONSTRUCTION SITE SHALL BE MULCHED WITH A 2 INCH LAYER OF PINE NEEDLES OR WOOD CHIPS. MULCHING TO A DEPTH, WHICH APPROACHES OR EXCEEDS 4 INCHES NEGATIVELY EFFECTS SOIL PROPERTIES AND CAN INHIBIT REVEGETATION. STRAW MULCH WILL NOT BE ACCEPTABLE. OTHER TECHNIQUES SUCH AS EROSION CONTROL BLANKETS CAN BE SUBSTITUTED FOR MULCH IF THEY ARE INSTALLED AND MAINTAINED ACCORDING TO MANUFACTURERS SPECIFICATIONS. CONSTRUCTION AREAS THAT REMAIN EXPOSED AFTER A 48-HOUR CORRECTION NOTICE HAS BEEN POSTED MAY BE SUBJECT TO DOUBLE FILING FEES PER TRPA REQUIREMENTS.
3. FENCING OF "NON-APPROVED: CONSTRUCTION AREAS SHALL BE SPECIFIED TO BE AT LEAST 48 INCHES HIGH AND SHALL BE CONSTRUCTED OF METAL POSTS AND EITHER ORANGE CONSTRUCTION FENCING OR METAL MESH FENCING ALSO AT LEAST 48 INCHES HIGH. JOB SITES WITH VIOLATIONS OF THE FENCING STANDARDS WILL BE REQUIRED TO RE-FENCE THE JOB SITE WITH A HIGH GAUGE METAL FENCING.
4. NO MATERIAL OR EQUIPMENT SHALL ENTER OR BE PLACED IN THE AREAS PROTECTED BY FENCING OR OUTSIDE THE APPROVED CONSTRUCTION AREA WITHOUT PRIOR APPROVAL FROM TRPA AND WASHOE COUNTY. FENCES SHALL NOT BE MOVED WITHOUT PRIOR APPROVAL. TO REDUCE SOIL DISTURBANCE AND DAMAGE TO VEGETATION, THE AREA OF DISTURBANCE DURING THE CONSTRUCTION OF A STRUCTURE SHALL BE LIMITED TO THE AREA BETWEEN THE FOOTPRINT OF THE BUILDING AND THE PUBLIC ROAD. FOR THE REMAINDER OF THE SITE, THE DISTURBANCE AREAS SHALL NOT EXCEED 12 FEET FROM THE FOOTPRINT OF THE STRUCTURE, PARKING AREA OR CUT/FILL SLOPE. THIS FENCING SHALL BE CLEARLY SHOWN ON THE APPROVED PLANS. ALL CHANGES OR EXCEPTIONS SHALL BE SHOWN ON A REVISED SET OF PLANS. FOR APPROVAL, ANY "IN-THE-FIELD: CHANGES SHALL BE APPROVED BY TRPA AND PLACER COUNTY PRIOR TO IMPLEMENTATION.
5. BMP's SHALL BE INSTALLED PRIOR TO THE COUNTY PRE-GRADE MEETING AND MAINTAINED THROUGHOUT THE CONSTRUCTION ACTIVITIES SHOWN ON THESE PLANS.
6. ALL BARREN AREAS AND AREAS DISTURBED BY CONSTRUCTION SHALL BE VEGETATED IN ACCORDANCE WITH THE TRPA HANDBOOK OF BEST MANAGEMENT PRACTICES. APPLICATION OF MULCH MAY ENHANCE VEGETATION.
7. ALL PROJECT RELATED VEHICLES SHALL PARK ON EXISTING PAVED SURFACES OR EXISTING COMPACTED ROAD SHOULDERS.
8. SOIL STOCKPILES SHALL NOT BE PLACED ON TOP OF EXISTING VEGETATION. ALL EXCAVATED MATERIAL SHALL BE PLACED UPHILL OF TRENCH LOCATIONS. ALL TEMPORARY STOCKPILES SHALL BE CONTAINED BY TEMPORARY EROSION CONTROL FENCES OR FIBER ROLL LOGS (12" MINIMUM DIAMETER) AND COVERED WITH NON-PERMEABLE MATERIAL AT THE END OF THE WORK DAY AND / OR DURING PERIODS OF PRECIPITATION OR HIGH WINDS.
9. DROP INLETS AND STORM WATER CONVEYANCE AND TREATMENT FACILITIES LOCATED DOWNSLOPE OF EXCAVATED MATERIAL SHALL BE PROTECTED BY TEMPORARY EROSION CONTROL FENCES OR FIBER ROLL LOGS (MINIMUM 12 INCH DIAMETER).
10. THE ESTABLISHMENT OF EQUIPMENT AND/ OR VEHICLE STORAGE AREAS OUTSIDE OF PREVIOUSLY DISTURBED ROAD SHOULD IS PROHIBITED UNLESS SPECIFICALLY AUTHORIZED BY TRPA.
11. ALL TEMPORARY EROSION CONTROL AND REVEGETATION PROTECTION FENCING SHALL BE MAINTAINED IN A FUNCTIONING CONDITION DURING CONSTRUCTION STAGING ACTIVITIES AND UNTIL THE SITE IS REVEGETATED.
12. ASPHALT CUTTINGS AND SOIL TRACKED ONTO PAVEMENT SHALL BE REMOVED THROUGH REGULAR SWEEPING AT THE END OF EACH BUSINESS DAY.

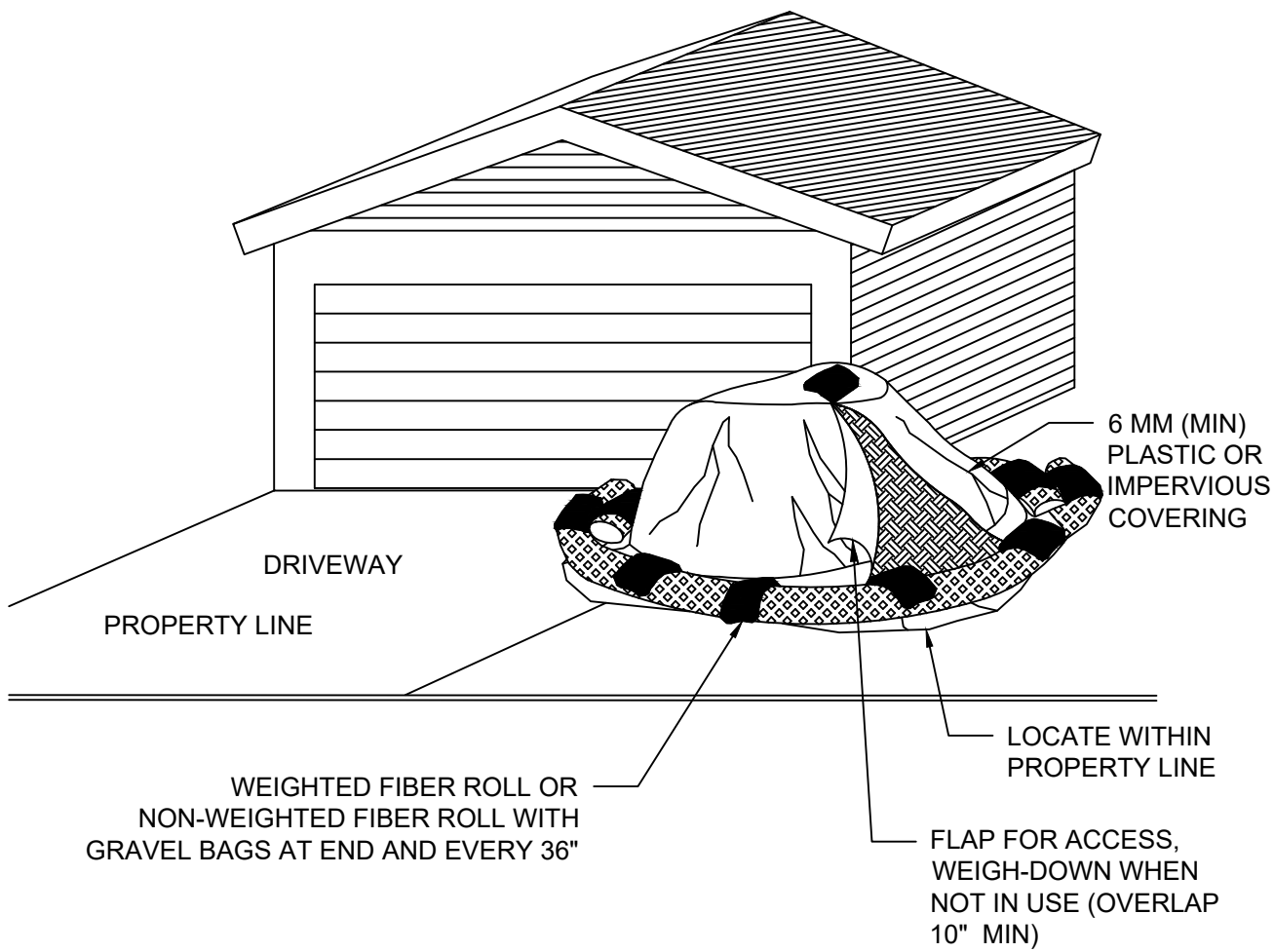

- NOTES:**
1. LOCATE STOCK AND/OR SPOIL PILES AWAY FROM DRAINAGE COURSES, DRAIN INLETS OR CONCENTRATED FLOWS OF STORMWATER.
 2. ALL STOCK AND/OR SPOIL PILE PERIMETERS SHALL BE PROTECTED WITH TEMPORARY LINEAR SEDIMENT BARRIERS.
 3. COVER ALL STOCK AND/OR SPOIL PILES WITH 6 MM PLASTIC, CANVAS TARP OR IMPERVIOUS COVER TO PREVENT WIND AND RAIN EROSION. EVENLY SPACE WEIGHTS (GRAVEL BAGS) ON COVER TO KEEP IN PLACE DURING WIND.
 4. CONDUCT REGULAR INSPECTIONS OF STOCK AND/OR SPOIL PILES DURING AND AFTER RAIN EVENTS
 5. VERY LARGE STOCK AND/OR SPOIL PILES MAY REQUIRE SILT FENCE IN LIEU OF FIBER ROLLS.
 6. REMOVE SPOIL PILES FROM CONSTRUCTION SITE AS SOON AS POSSIBLE.
 7. STOCK/SPOIL PILES MUST BE STORED WITHIN THE APPROVED STAGING AREA.

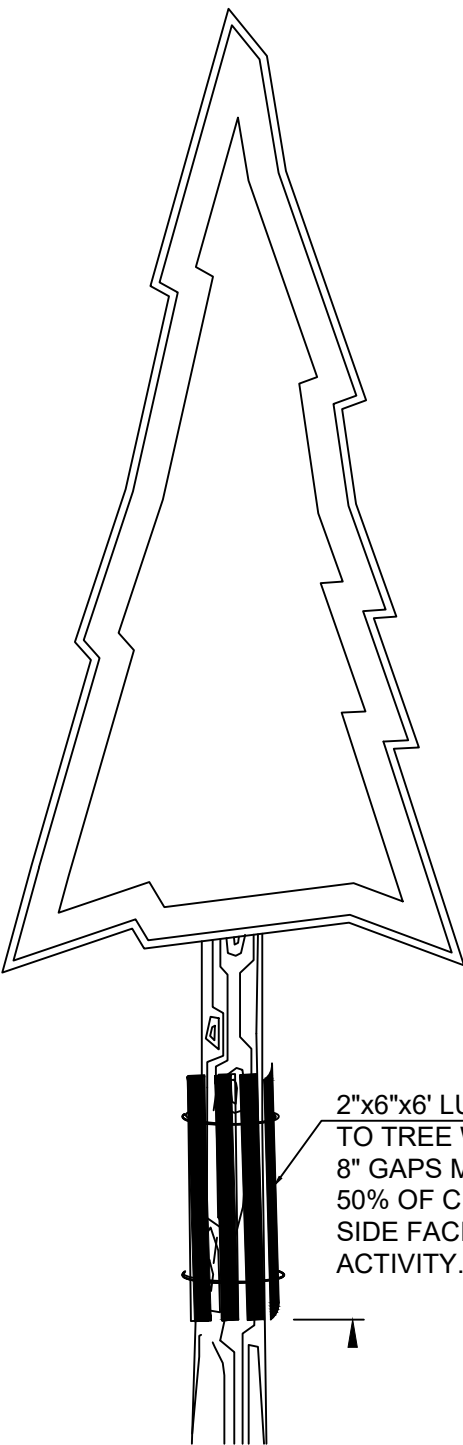

1	CONSTRUCTION FENCING
D1.1	N.T.S

3	STOCKPILE MANAGEMENT
D1.1	N.T.S

4	INDIVIDUAL TREE PROTECTION
D1.1	N.T.S

2	FIBER ROLLS
D1.1	N.T.S

5	EROSION CONTROL NOTES
D1.1	N.T.S

6	EROSION CONTROL NOTES
D1.1	N.T.S

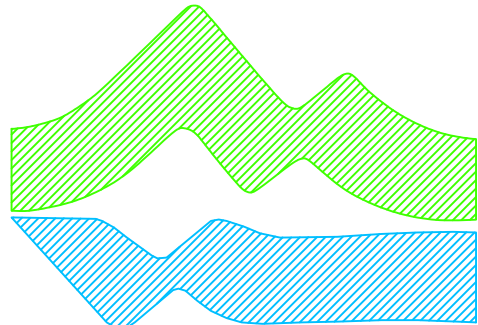

INCLINE VILLAGE
GENERAL IMPROVEMENT
DISTRICT

1220 SWEETWATER RD.
INCLINE VILLAGE, NV 89451
P: 775.832.1203

PONDEROSA & TUNNEL CREEK WATER MAIN
REPLACEMENT

REVISION # DATE REVISION DESCRIPTION

PROJECT #:

2299WS1803

DATE:

10/3/2024

SHEET SCALE:

N.T.S

SHEET DESCRIPTION:

DETAIL SHEET 1

SHEET #:

D1.2

PAGE #:

9 OF 12

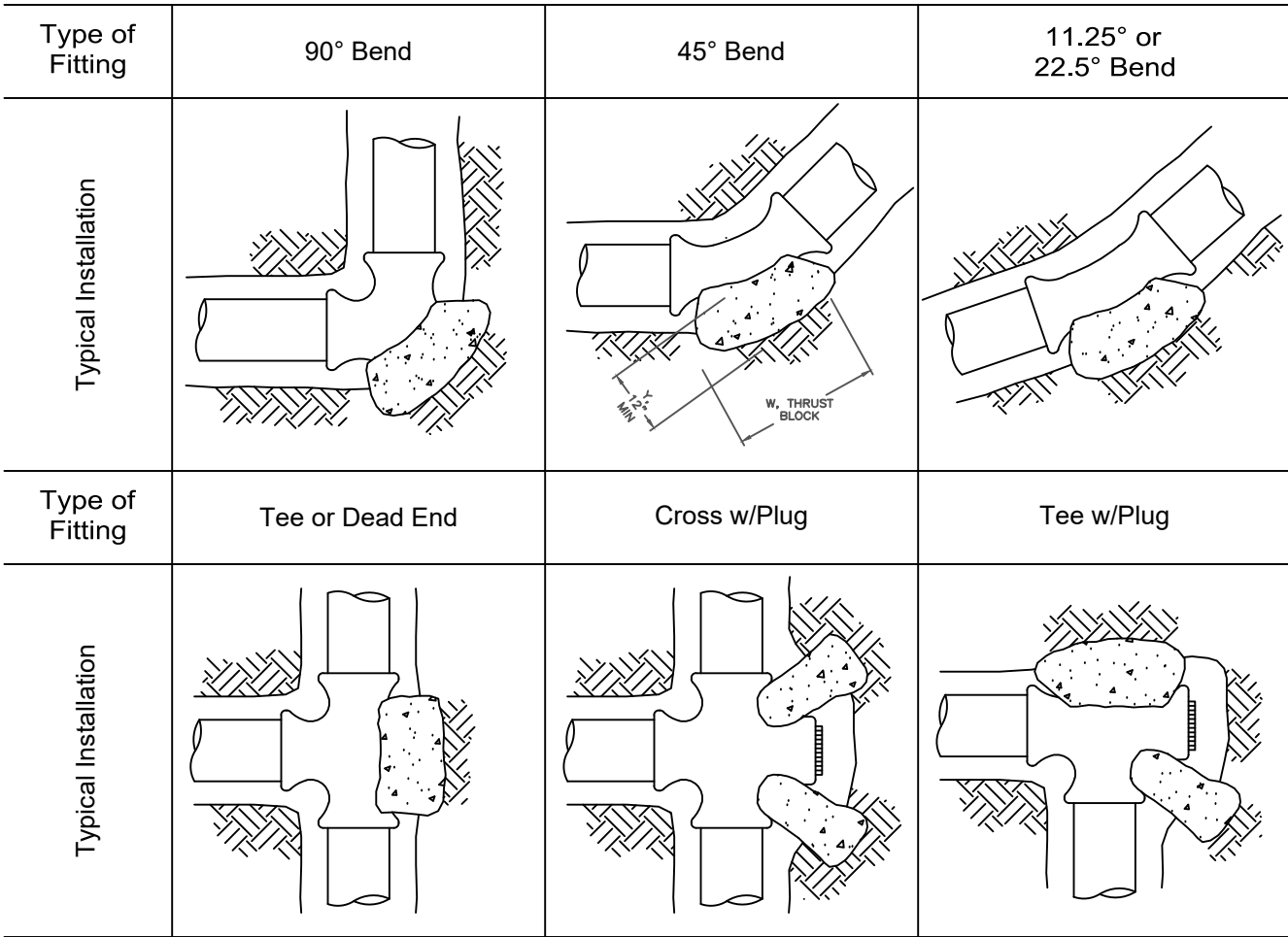

Minimum Thrust Block Bearing Area - Square Feet (Y x W)

Type of Fitting		90° Bend, Cross w/Plug or Tee w/Plug	45° Bend	11.25° or 22.5° Bend	Tee or Dead End
Size of Pipe	4"	2	1	1	2
	6"	5	3	2	4
	8"	8	5	3	6

NOTES:

- CONCRETE FOR THRUST BLOCKS SHALL CONFORM TO SECTION 337.10 OF THE STANDARD SPECIFICATIONS FOR PUBLIC WORKS CONSTRUCTION AND SHALL HAVE A MINIMUM COMPRESSIVE STRENGTH OF 4000 PSI AT 28 DAYS.
- THRUST BLOCKS SHALL BE PLACED AGAINST UNDISTURBED SOIL.
- JOINTS AND FACE OF PLUGS SHALL BE KEPT CLEAR OF CONCRETE.
- THRUST BLOCK BEARING AREAS ARE FOR A 200 PSI TEST PRESSURE WITH 2000 PSF BEARING CAPACITY, NOMINAL PIPE DIAMETER, AND A FACTOR OF SAFETY OF 1.5 INSTALLATIONS USING DIFFERENT TEST PRESSURES, AND/OR SOIL TYPES SHALL BE ADJUSTED BY THE DESIGN ENGINEER.
- ALL JOINTS SHALL BE POLYWRAPPED (VIRGIN POLYETHYLENE, 8 MILS THICK).

1 THRUST BLOCK DETAIL

D1.2 N.T.S

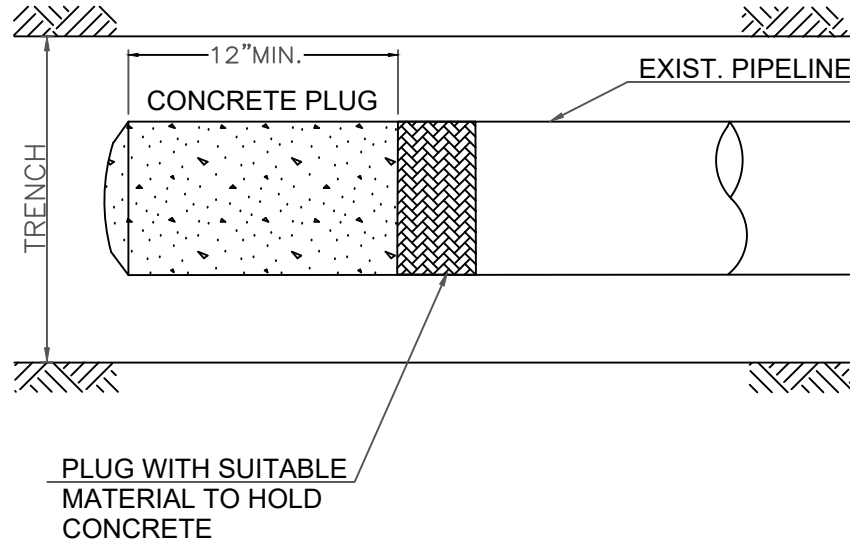

NOTES:

- PRIOR DISTRICT APPROVAL REQUIRED FOR CUTTING AND PLUGGING.

3 PLUG EXISTING PIPE

D1.2 N.T.S

PVC PIPE - RESTRAINT LENGTH CHART (FT)												
	TEES (SEE NOTE 3)		BENDS					REDUCERS (SEE NOTE 4)				
PIPE Ø (IN)	BRANCH/RUN (IF LENGTH TO FIRST JOINT ALONG RUN=20')	BRANCH/RUN (IF LENGTH TO FIRST JOINT ALONG RUN=20')	90°	45°	22.5°	11.25°	DEAD END	12" x PIPE Ø	10" x PIPE Ø	8" x PIPE Ø	6" x PIPE Ø	4" x PIPE Ø
6"	2/20	38/20	49	21	10	5	89	236	141	63	N/A	46
8"	17/20	54/20	64	27	13	7	117	131	58	N/A	49	84

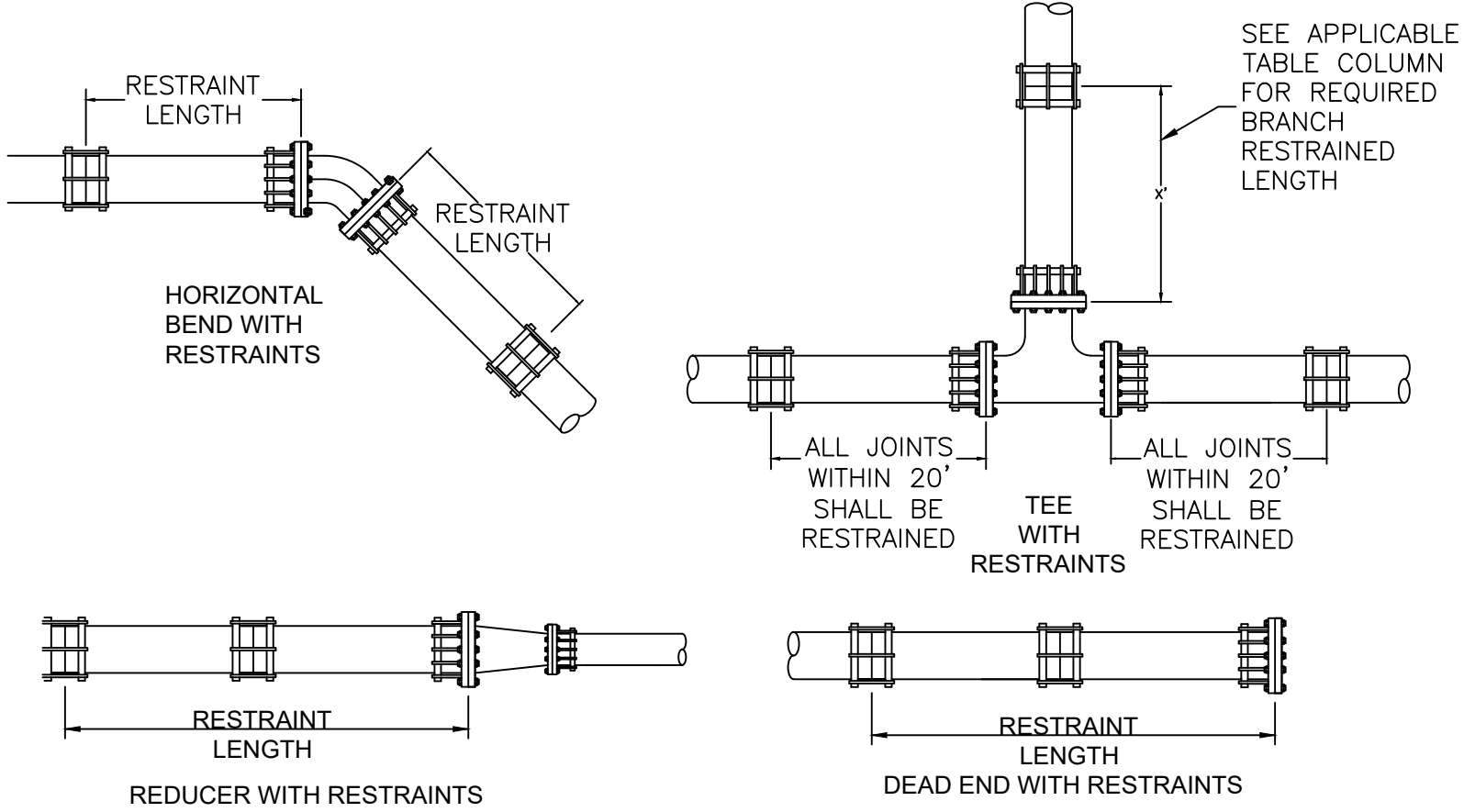

NOTES:

- IF BELL RESTRAINTS ARE USED ACCORDING TO THIS CHART, THRUST BLOCKS ARE NOT REQUIRED ON BENDS, TEES, HYDRANTS, VALVES OR OTHER AREAS. CITY MAY REQUIRE USE THRUST BLOCKS DEPENDING ON SOIL CONDITIONS.
- CONTRACTOR SHALL SUBMIT RESTRAINT CAPABILITY OF THE BELL RESTRAINTS SUPPLIED FOR APPROVAL BY ENGINEER PRIOR TO USE.
- IF FULL 20' STICK OF PIPE IS NOT INSTALLED IN "RUN" DIRECTION OF TEE, THEN "BRANCH" DIRECTION WILL BE RESTRAINED TO A LENGTH INDICATED IN COLUMN "BRANCH/RUN (IF LENGTH TO FIRST JOINT ALONG RUN <20)". MIN LENGTH TO FIRST JOINT ALONG RUN IS 5 FEET. ALL RESTRAINTS TO BE PLACED ON LARGE SIDE OF THE REDUCER.
- RESTRAINED LENGTHS APPLICABLE FOR HORIZONTAL AND VERTICAL BENDS.
- ALL JOINTS WITHIN THE CALCULATED LENGTH MUST BE RESTRAINED.
- IF DISTANCE BETWEEN FITTINGS IS LESS THAN OR EQUAL TO THE CALCULATED RESTRAINT LENGTH, RESTRAIN ALL JOINTS BETWEEN FITTINGS.

RESTRAINT LENGTH CALCULATION ASSUMPTIONS:
• SOIL TYPE="CH" INORGANIC CLAYS, ETC.
• SOIL COVER=3.5'
• FACTOR OF SAFETY=1.5
• TRENCH=90% COMPACTION
• TEST PRESSURE=200 PSI

2 JOINT RESTRAINT CHART DETAIL - PVC PIPE

D1.2 N.T.S

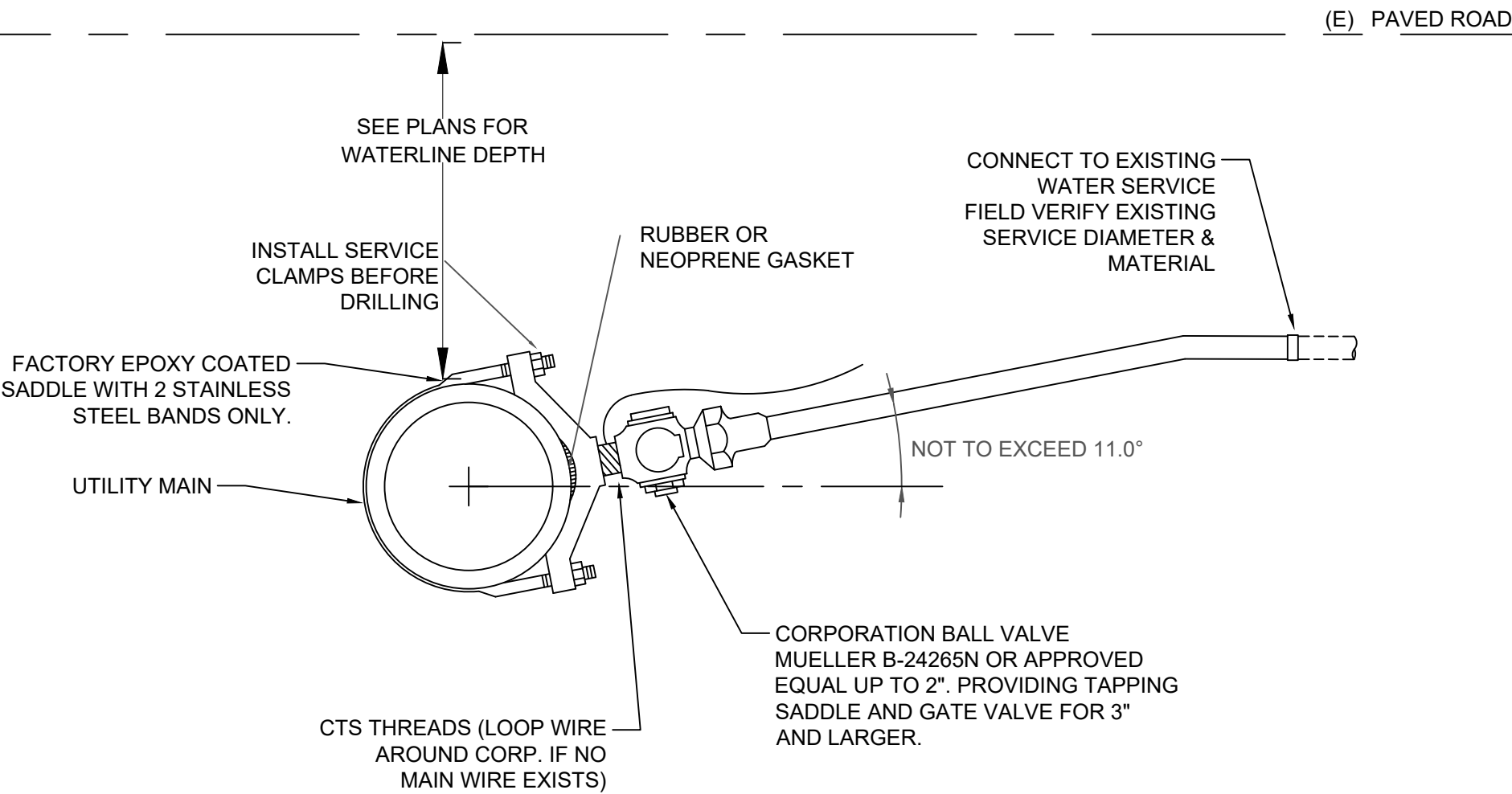

NOTES:

- MINIMUM 5' SPACING BETWEEN WATER SERVICE CONNECTIONS

4 WATER SERVICE DETAIL

D1.2 N.T.S

U:\Engineering\Projects\Current & Ongoing Projects\2024 2299WS1803 Ponderosa Ranch Road Waterlines1 - Design\XX%\Drawings\04 Ponderosa WL_ Detail Sheet.dwg

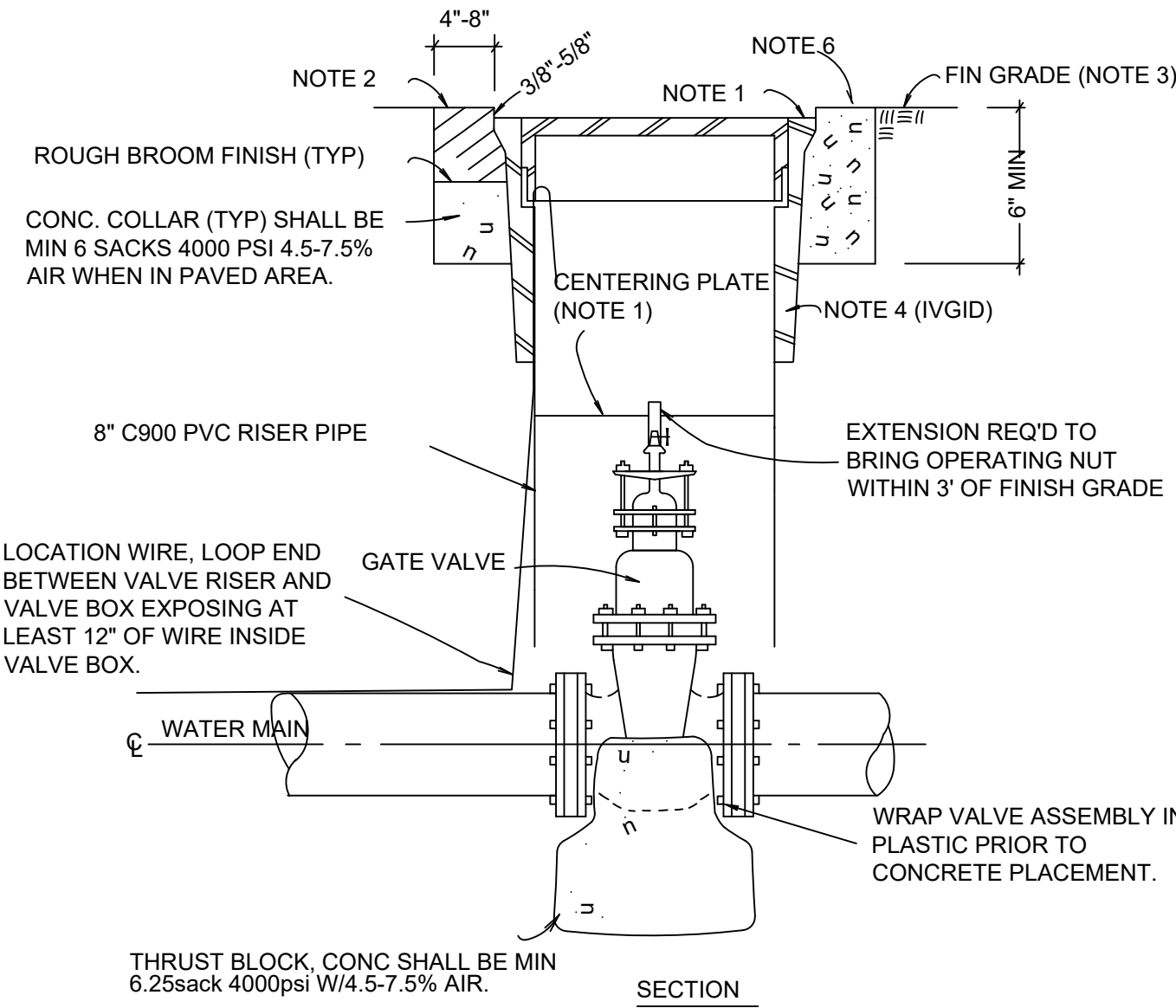

NOTES:

1. VALVE BOXES FOR WATER TO BE SET 3/8" - 5/8" BELOW FINISH ROADWAY SURFACE. WHEN OPERATING NUT IS AT GREATER DEPTH THAN 4' FROM FINISH GRADE INSTALL OPERATING EXTENSION W/OPERATING NUT RESTRAINING BOLT & TOP CENTERING PLATE.
2. CONC COLLAR TO BE LEFT 2" BELOW FINISH ASPH SURFACE. PLACE 2" OF TYPE 3 ASPH PAVING AROUND VALVE BOX, APPLY SS-1 TACK COAT BEFORE PAVING. SEAL A.C. SURFACE W/SS-1 & SAND BROOMED-IN. CHIP SEAL, SAND SEAL OR SLURRY SEAL PAVED SURFACE AS REQ'D BY PLANS OR SPECS. EXTEND CONC COLLAR TO FIN. GRADE WHEN NOT LOCATED IN ASPHALT PAVEMENT OR IN UNPAVED AREA.
3. THE ORIGINAL FINISHED GRADE SHALL BE MAINTAINED AT ALL TIMES. (i.e: ANY A.C. CURLING ALONG FINISHED GRADE EDGE SHALL BE CORRECTED) ONLY THE ASPHALT COLLAR SHALL BE LEVEL W/FIN GRADE.
4. INCLINE VILLAGE GENERAL IMPROVEMENT DIST. (IVGID): WATER VALVE BOX SHALL BE CHRISTY G-5.
5. ONLY CIRCULAR TYPE CUTTING PERMITTED TO RAISE UTILITIES, i.e: NO RECTANGULAR TYPE SAW-CUTTING ALLOWED.
6. CONCRETE COLLAR TO FINISHED GRADE IN NDOT R.O.W. AND NON-PAVED AREAS.

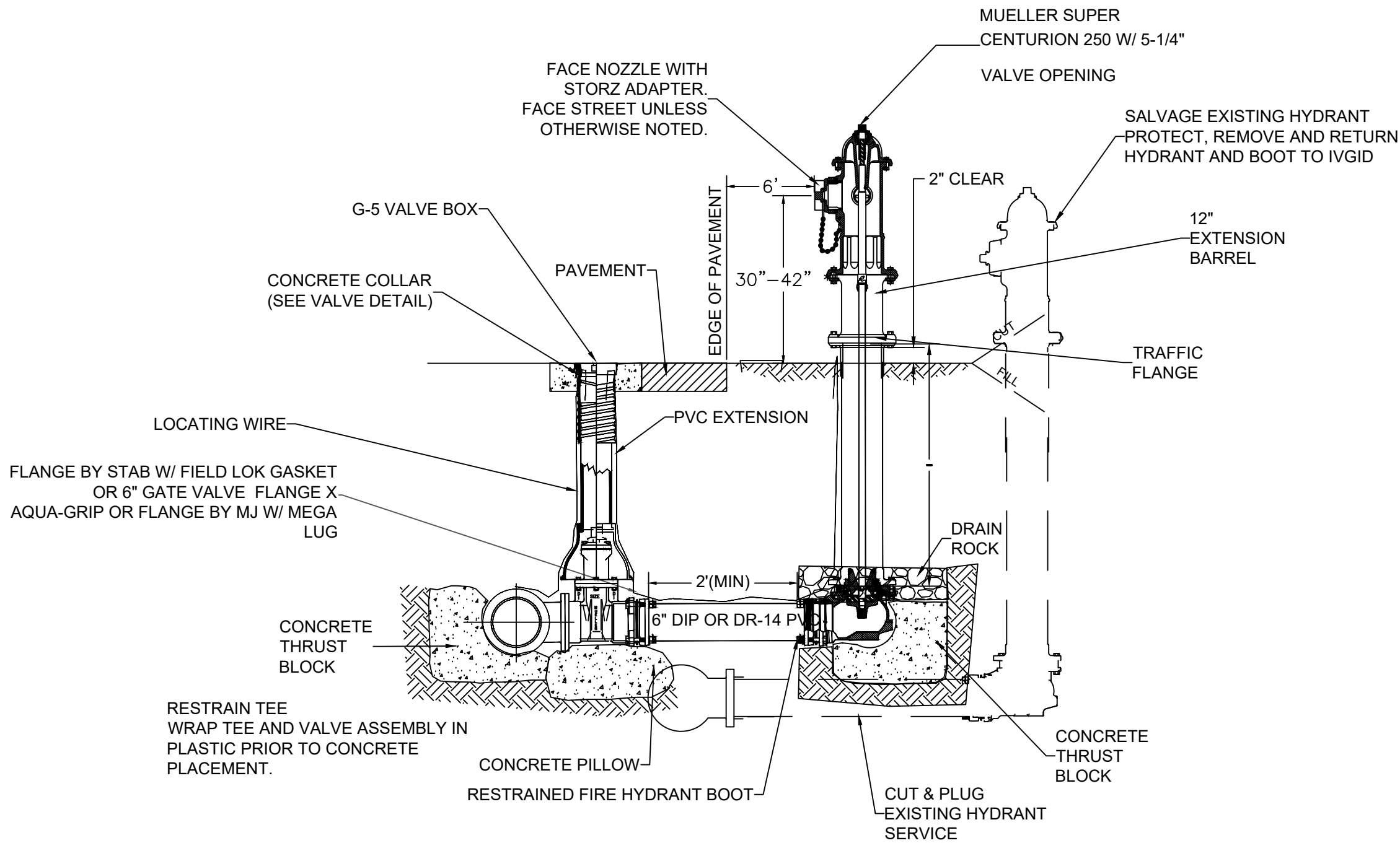

NOTES:

1. HYDRANTS SHALL BE ENAMELED RED.
2. ALL HYDRANTS SHALL HAVE (2) 2-1/2" HOSE NOZZLES AND (1) 4-1/2" STEAMER NOZZLE. ALL THREADS SHALL BE NATIONAL STANDARD.
3. OPERATING NUT SHALL BE 1-1/2" PENTAGON.
4. HYDRANT W/ AQUA-GRIP SHOE OR STAB W/FIELD LOK GASKET
5. CONFIRM HYDRANT LOCATION WITH NLTFPD AND IVGID PRIOR TO PLACEMENT
6. TWO (2) BOLLARDS ARE REQUIRED. LOCATION AS DETERMINED IN FIELD BY NLTFPD AND IVGID.
7. * DISTANCE ABOVE CURB WHERE EXISTS
8. SEE TRENCH DETAIL FOR BACKFILL REQUIREMENTS.

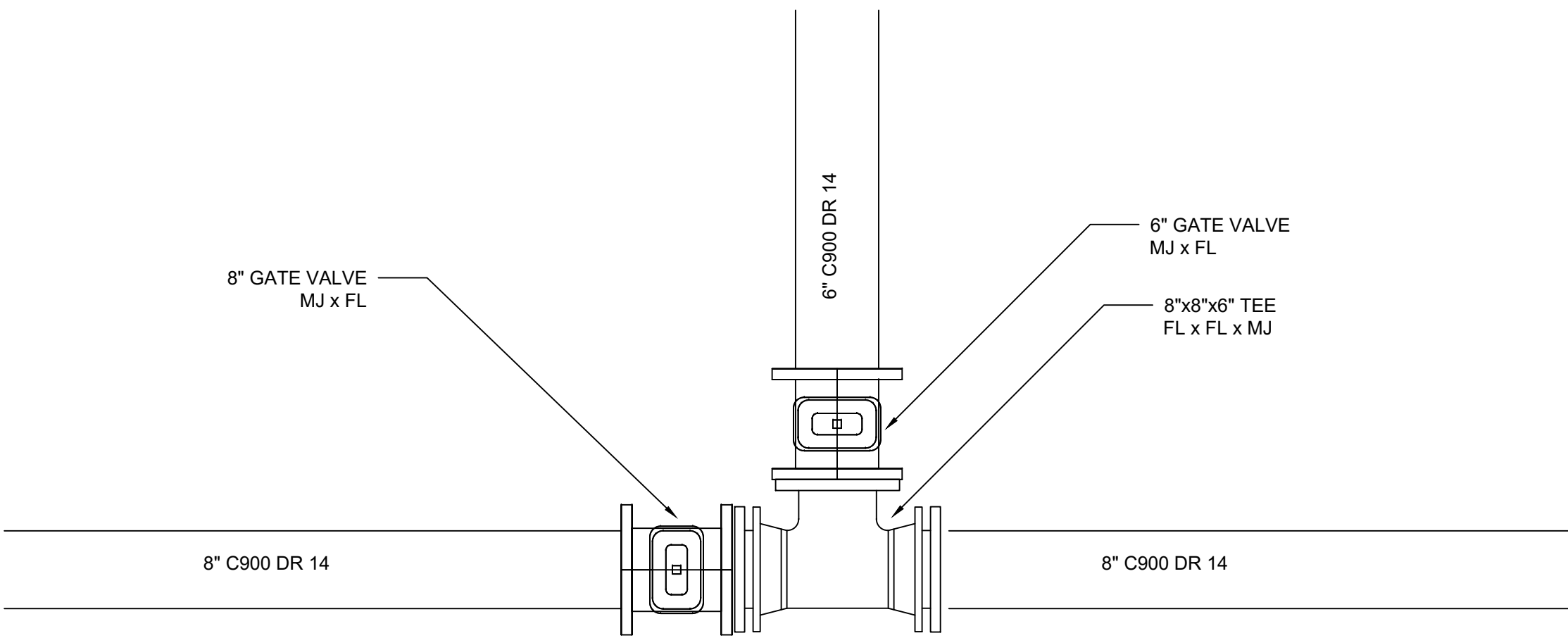

NOTES:

1. SEE DETAIL 1 SHEET D1.2 FOR THRUST BLOCK INSTALLATION REQUIREMENTS.
2. SEE DETAIL 2 SHEET D1.2 FOR JOINT RESTRAINT REQUIREMENTS.
3. SEE DETAIL 1 SHEET D1.3 FOR GATE VALVE INSTALLATION REQUIREMENTS.
4. SEE DETAIL 2 SHEET D1.3 FOR FIRE HYDRANT INSTALLATION REQUIREMENTS

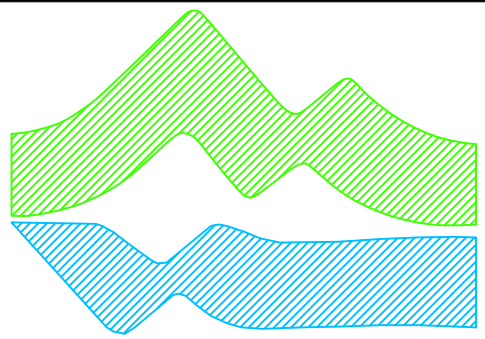
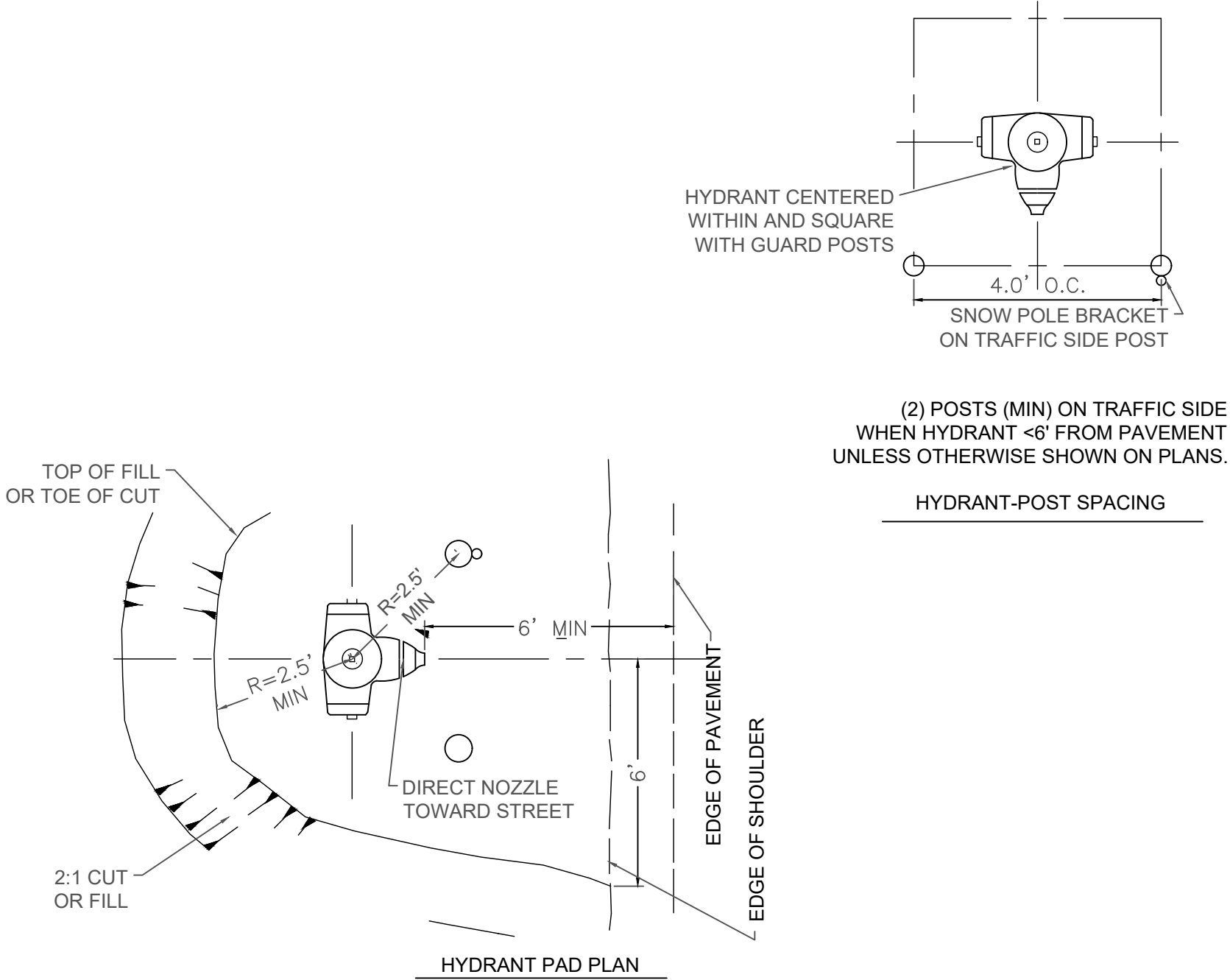
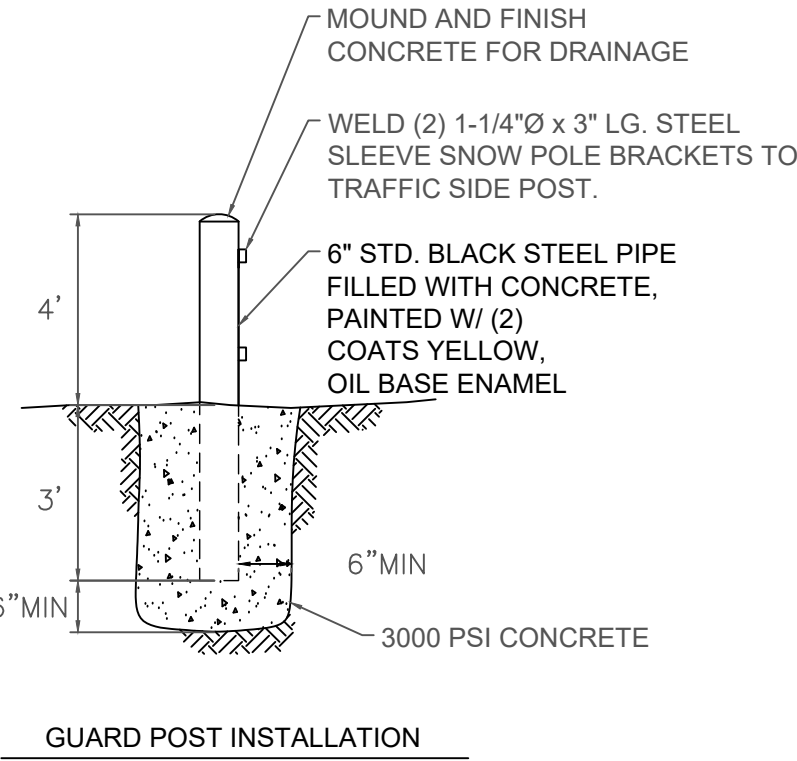

INCLINE VILLAGE
GENERAL IMPROVEMENT
DISTRICT

1220 SWEETWATER RD.
INCLINE VILLAGE, NV 89451
P: 775.832.1203

PONDEROSA & TUNNEL CREEK WATER MAIN
REPLACEMENT

REVISION # DATE REVISION DESCRIPTION

PROJECT #:

2299WS1803

DATE:

10/3/2024

SHEET SCALE:

N.T.S

SHEET DESCRIPTION:

DETAIL SHEET 2

SHEET #:

D1.3

PAGE #:

10 OF 12

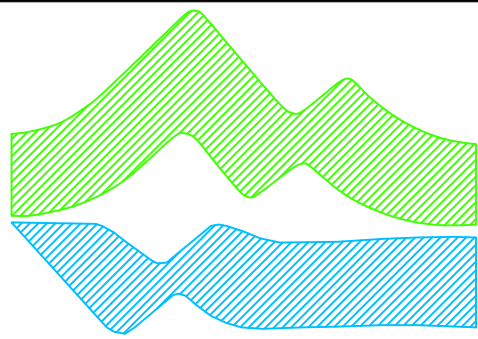

INCLINE VILLAGE
GENERAL IMPROVEMENT
DISTRICT

1220 SWEETWATER RD.
INCLINE VILLAGE, NV 89451
P: 775.832.1203

PONDEROSA & TUNNEL CREEK WATER MAIN
REPLACEMENT

REVISION #	DATE	REVISION DESCRIPTION

PROJECT #:
2299WS1803

DATE:
10/3/2024

SHEET SCALE:
N.T.S

SHEET DESCRIPTION:
DETAIL SHEET 3

SHEET #:	PAGE #:
D1.4	11 OF 12

PAVEMENT NOTES:

1. INCLINE VILLAGE PERMANENT PATCH TO MATCH THE DEPTH OF THE CONTIGUOUS PAVEMENT, BUT NO LESS THAN 6 INCHES AND NO MORE THAN 8 INCHES.
2. A STREET CUT PERMIT MUST BE OBTAINED FROM WASHOE COUNTY COMMUNITY SERVICES DEPARTMENT PRIOR TO CUTTING ANY PUBLIC RIGHT-OF-WAY.
3. ALL CONCRETE AND ASPHALT REMOVAL AND REPLACEMENT SHALL BE TO SAW-CUT LINES AND SHALL BE DONE BY EXCAVATION CONTRACTOR OR SUBCONTRACTOR. ALL SAW-CUTS SHALL BE VERTICAL AND IN STRAIGHT LINES PARALLEL OR PERPENDICULAR TO THE TRENCH OR TO THE SATISFACTION OF THE COUNTY ENGINEER.
4. NOT USED
5. HOT MIX ASPHALT SHALL BE TYPE 3, PG64-28 (OR COUNTY APPROVED EQUIVALENT), 3% VOIDS, 50 BLOWS PER SIDE MIX WITH LIME AND NO MORE THAN 15% RECYCLED ASPHALT PAVEMENT COMPACTED TO A MINIMUM OF 93% RICE RELATIVE COMPACTION.
6. ALL CONSTRUCTION SHALL BE IN ACCORDANCE WITH THE LATEST EDITION OF THE STANDARD SPECIFICATIONS FOR PUBLIC WORKS CONSTRUCTION.
7. DEPTH OF BASE TO BE 6" MINIMUM OR MATCH EXISTING BASE IF GREATER, INCLUDING UNPAVED STREETS.
8. USE OF ROCK WHEEL TRENCHING MACHINES OR SIMILAR EQUIPMENT SHALL NOT BE PERMITTED WITHIN PAVED AREAS OR WITHIN 1 FOOT OF EDGE OF PAVING.
9. CONCRETE SLURRY WITH MINIMUM OF 1 SACK OF CEMENT PER CUBIC YARD OF SLURRY OR OTHER APPROVED MIX DESIGN MAY BE USED FOR BASE COURSE, BEDDING OR BACKFILL IF APPROVED BY THE COUNTY ENGINEER AND UTILITY COMPANIES.
10. PERMANENT RESURFACING SHALL NOT BE PLACED ON TRENCHES BACKFILLED WITH CONCRETE SLURRY FOR A MINIMUM OF 7 DAYS AFTER PLACEMENT OF THE CONCRETE SLURRY OR SIMILAR MATERIAL.
11. ALL TEMPORARY PATCHES SHALL BE HOT-MIX ASPHALT A MINIMUM OF 3 INCHES THICK AND MUST BE INSTALLED WITHIN 24 HOURS AFTER THE TRENCH IS BACKFILLED, OR COVERED WITH STEEL PLATES AND BARRICADED TO THE SATISFACTION OF THE COUNTY ENGINEER.
12. A NEGOTIATED RECONSTRUCTION, INCLUDING BUT NOT LIMITED TO GRIND AND OVERLAY, SHALL BE DETERMINED BY THE COUNTY ENGINEER DEPENDENT UPON THE EXTENT OF THE TRANSVERSE AND LONGITUDINAL EXCAVATIONS.
13. ALL PERMANENT PAVEMENT PATCHES REQUIRE ASPHALT SEAL COATS. THE TYPE SHALL BE DETERMINED BY THE COUNTY ENGINEER.

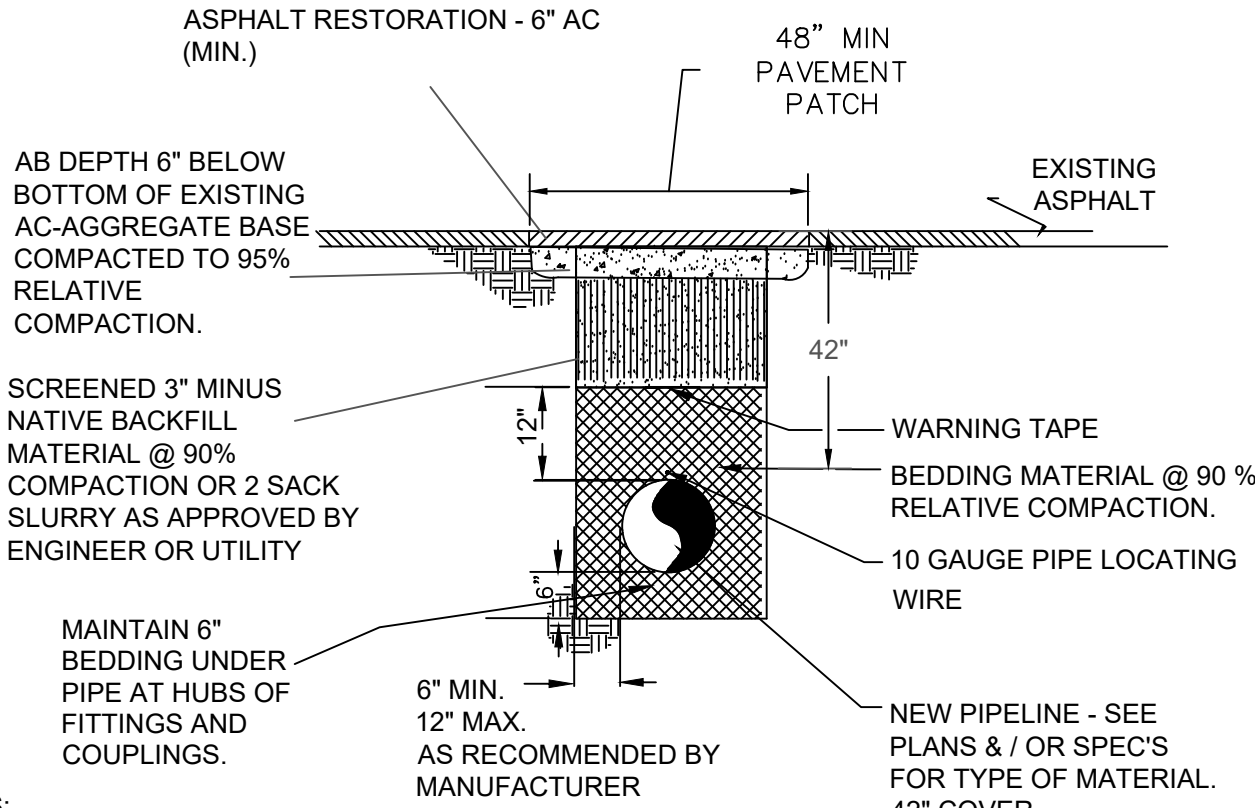
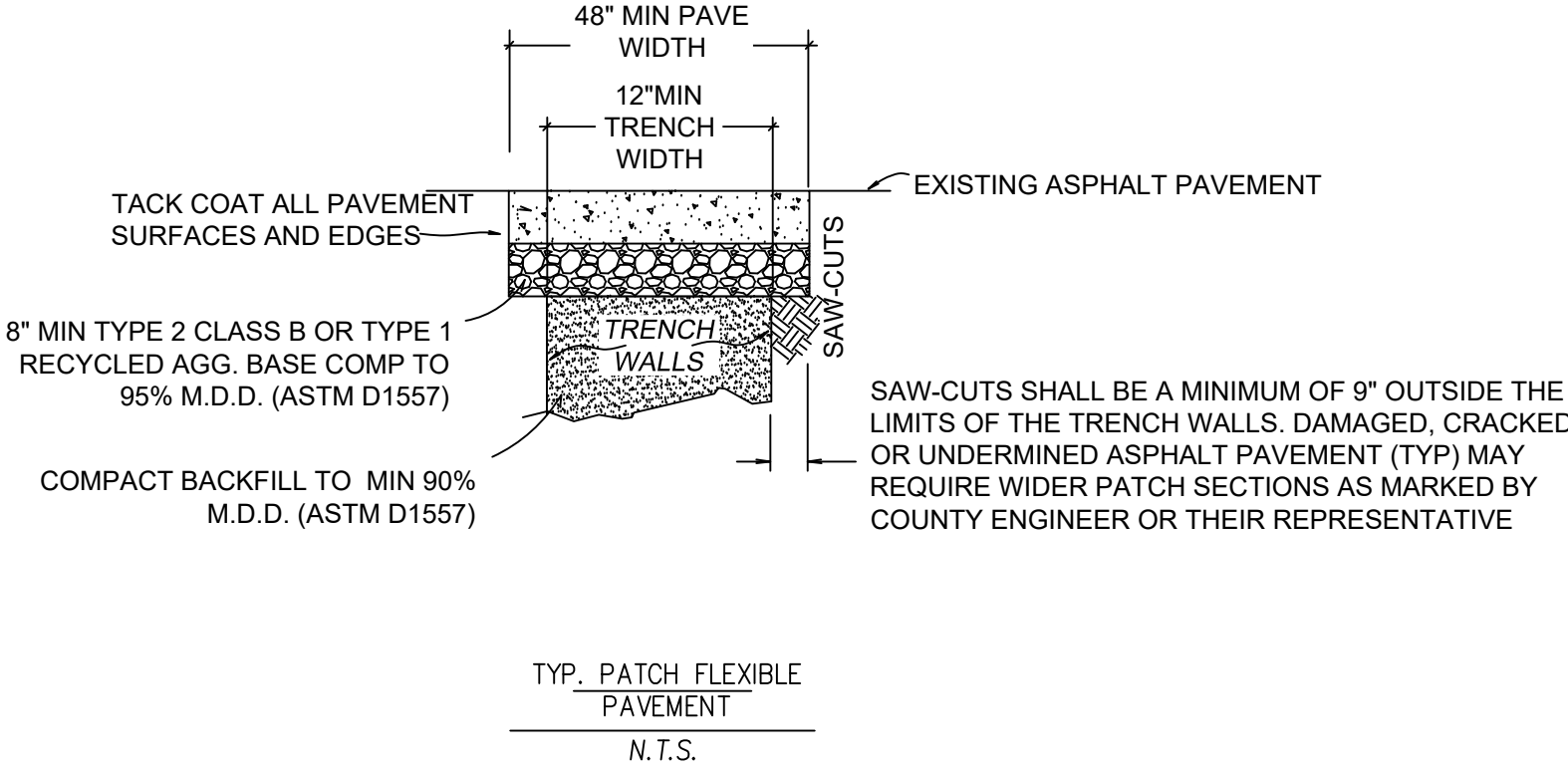

NOTES:

1. TEMPORARY ROAD REPAIRS TO BE SAWCUT STRAIGHT AND PAVED WITH HOT MIX AS NOTED.
2. PERMANENT DRIVEWAY REPAIRS TO BE CONSTRUCTED IN ACCORDANCE WITH WASHOE COUNTY STANDARD DETAILS FOR ASPHALT DRIVEWAY APRONS.
3. ALL ROAD SHOULDERS TO BE COMPACTED TO 95% RELATIVE COMPACTION (NO REVEGETATION REQUIRED)
4. WATER MAIN DEPTH MINIMUM OF 42" COVER TO TOP OF PIPE TYPICAL. AREAS WHERE MAIN IS SHALLOW TO MISS CULVERTS OR SEWER LINES THE WATERMAIN SHALL BE CONCRETE ENCASED 10 FEET BEYOND BOTH SIDES OF THE INTERSECTION WITH OTHER UTILITY.
5. ALL PROTRUDING ROCKS WILL BE REMOVED PRIOR TO PIPE INSTALLATION.
6. DUCTILE IRON PIPE WILL HAVE A POLYETHYLENE ENCASEMENT PER AWWA C105
7. CONC SLURRY W/MIN OF 2 SACK OF CEMENT PER CU.YD. OF SLURRY OR OTHER APPROVED MIX DESIGN MAY BE USED FOR BASE COURSE, BEDDING OR BACKFILL IF APPROVED BY CO. ENGINEER & UTILITY COMPANIES.
8. PERMANENT RESURFACING SHALL NOT BE PLACED ON TRENCHES BACKFILLED W/CONC SLURRY FOR A MIN OF 7 DAYS AFTER PLACEMENT OF THE CONC SLURRY OR SIMILAR MATERIAL.

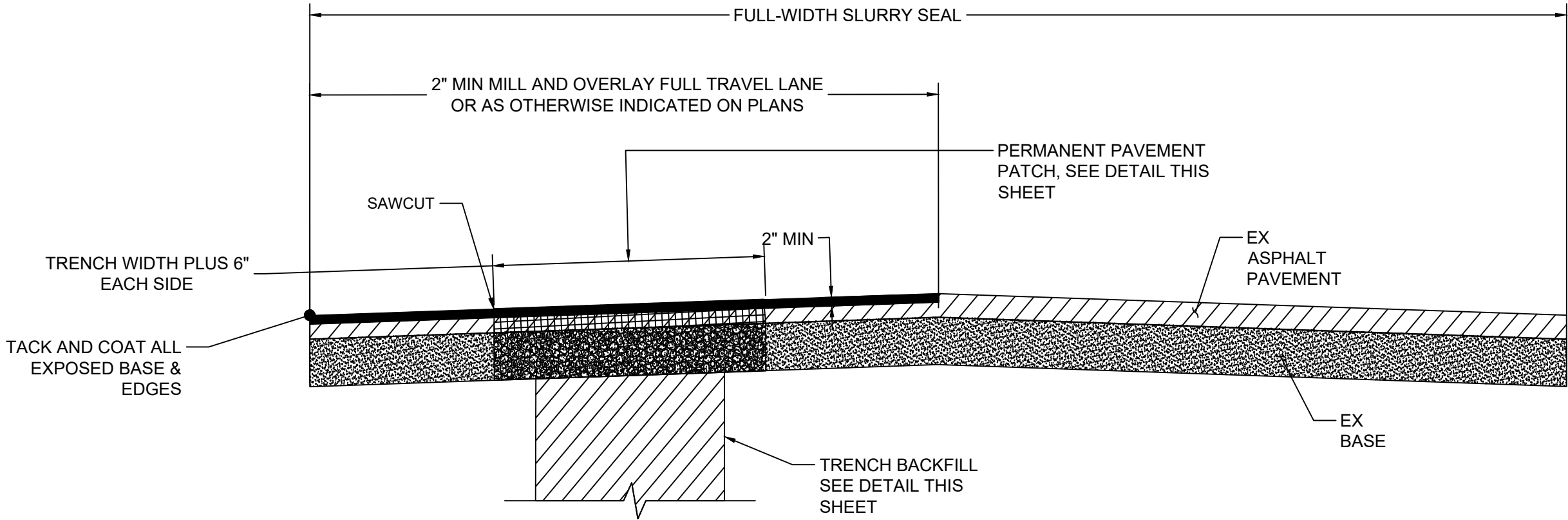

NOTES:

1. 24 HOURS PRIOR TO TRENCH EXCAVATION, THE CONTRACTOR MUST NOTIFY THE COUNTY, THE OWNER, AND THE ENGINEER.
2. IF SAWCUT IS WITHIN 2 FEET OF EXISTING PAVEMENT EDGE OR EXISTING PAVEMENT PATCH, REMOVE EXISTING PAVEMENT TO THAT EDGE AND REPLACE ENTIRE SECTION.
3. ALL A.C. REPLACEMENT REQUIREMENTS ARE MINIMUM WIDTHS ONLY. THE COUNTY OR THE ENGINEER MAY REQUIRE WIDER PATCH SECTIONS OR OTHERWISE ALTER THOSE REQUIREMENTS.
4. PERMANENT PAVEMENT PATCHES SHALL COMPLY WITH DETAIL 3 ON THIS SHEET.
5. COLD PATCHES FOR TEMPORARY PATCHING, CAN BE A DURAPATCH (PRODUCT 1707 3/8" COLD MIX) OR EX STREET FROM SYAR INDUSTRIES.
6. ANY CONDITIONS OF THE WASHOE COUNTY ENCROACHMENT/EXCAVATION PERMIT WHICH MAY DIFFER FROM ABOVE WILL GOVERN IN APPLICABLE AREAS.
7. SLURRY SEAL SHALL BE APPLIED TO NEW AND EXISTING PAVEMENT SURFACES FROM EOP TO OPPOSITE EOP FOR THE LENGTH OF THE WORK.
8. ALL HMA SHALL MEET THE REQUIREMENTS OF NOTE 5 IN PERMANENT PAVEMENT PATCH NOTES, DETAIL 3, THIS SHEET.
9. ALL COLLARS SHALL BE ADJUSTED TO MEET SURFACE TOLERANCES NOTED IN THE SSPWC.

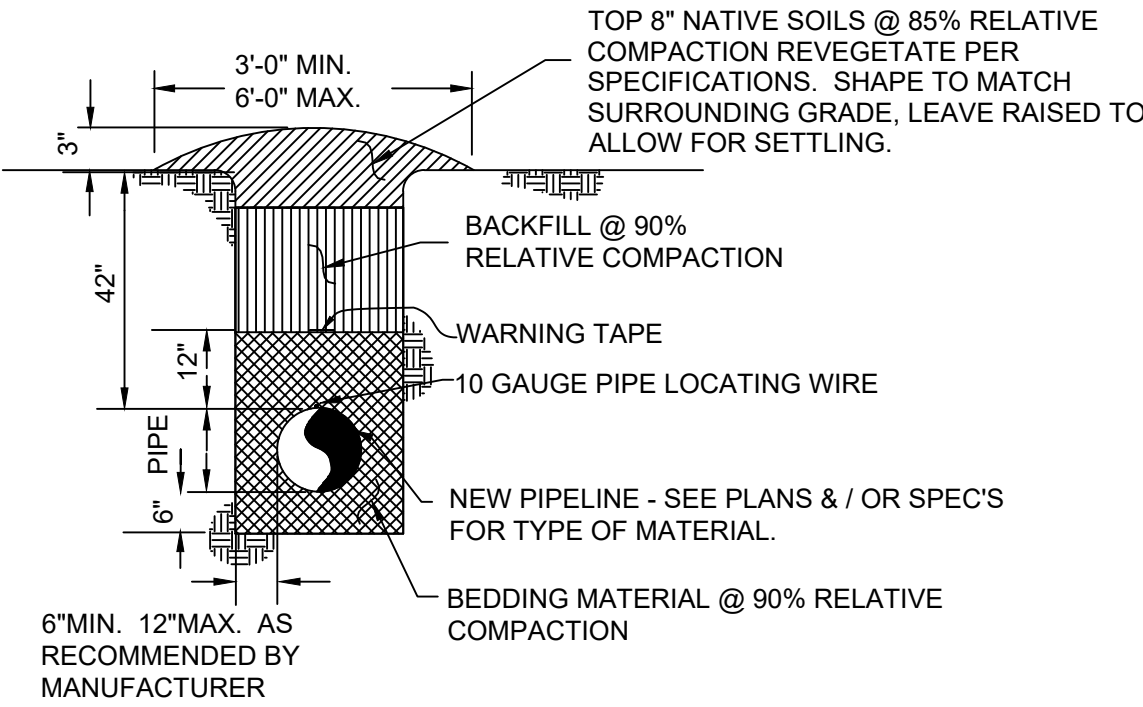

NOTES:

1. COVER TO BE MINIMUM OF 42 INCHES FROM TOP OF PIPE TO FINISHED SURFACE GRADE.
2. BOTTOM OF TRENCH SHALL BE LEVEL AND SMOOTH.
3. EXCAVATE AS NEEDED TO MAINTAIN 6" MINIMUM BEDDING UNDER PIPE AT COUPLINGS AND HUBS OF FITTINGS.
4. ALL BEDDING MATERIAL SHALL BE COMPACTED PRIOR TO SHAPING TRENCH & INSTALLATION OF PIPE.
5. ALL PROTRUDING ROCKS TO BE REMOVED.

U:\Engineering\Projects\Current & Ongoing Projects\2024 2299WS1803 Ponderosa Ranch Road Waterlines\1 - Design\XX% Designs\Drawings\04 Ponderosa WL- Detail Sheet.dwg

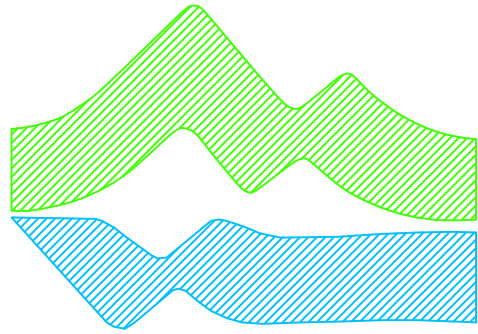

INCLINE VILLAGE
GENERAL IMPROVEMENT
DISTRICT

1220 SWEETWATER RD.
INCLINE VILLAGE, NV 89451
P: 775.832.1203

PONDEROSA & TUNNEL CREEK WATER MAIN
REPLACEMENT

REVISION #

DATE

REVISION DESCRIPTION

PROJECT #:

2299WS1803

DATE:

10/3/2024

SHEET SCALE:

N.T.S

SHEET DESCRIPTION:

DETAIL SHEET 4

SHEET #:

D1.5

PAGE #:

12 OF 12

VERTICAL CROSSING CONFLICT NOTES

"WATER" INCLUDES WATER MAINS AND LATERALS.

"SEWER" INCLUDES SANITARY SEWER, STORM DRAIN AND RECLAIMED WASTEWATER MAINS AND LATERALS.

"SLEEVE" MEANS ENCASING THE WATER OR SEWER WITH A 20' LENGTH OF AWWA C900 CLASS 100 OR GREATER WATER QUALITY PIPE, CENTERED AT THE POINT OF WATER/SEWER CROSSING. TO AVOID BEING GROUTED IN PLACE, THE WATER MAIN INSIDE THE SLEEVE MUST HAVE A DIAMETER EQUAL TO OR GREATER THAN 2/3 THE DIAMETER OF THE SLEEVE. USE OF A "SLEEVE" IS AN ACCEPTABLE ALTERNATIVE TO CENTERING THE WATER AND SEWER AT THE POINT OF CROSSING.

"RESTRAIN" MEANS USING MECHANICAL COUPLINGS TO RESTRICT JOINT MOVEMENT OR SEPARATION OF PIPE JOINTS WITHIN 10' EACH SIDE OF THE POINT OF CROSSING.

"SPECIAL CONSTRUCTION" IDENTIFIES ACCEPTABLE MITIGATION OR PROTECTION THAT ADDRESSES PHYSICALLY CONSTRAINED ENVIRONMENTS WHERE THE REQUIREMENTS OF NAC 445A.67175 INCLUSIVE CANNOT BE MET. AREAS OF "SPECIAL CONSTRUCTION" ARE TO BE IDENTIFIED ON THE PLANS IN PLAN VIEW USING CROSS-HATCHING AND IN PROFILE VIEW BY REFERENCING A STANDARD DETAIL.

"CONCRETE ENCASEMENT" OF THE WATER AS MITIGATION OR PROTECTION IS DISCOURAGED.

EVERY EFFORT IS TO BE MADE TO KEEP WATER MAIN OR WATER LATERAL 18" ABOVE SEWER MAIN AND WATER MAIN 12" ABOVE SEWER LATERAL. OTHERWISE, THE FOLLOWING SPECIAL CONSTRUCTION METHODS APPLY:

- SEWER MAIN ABOVE WATER MAIN, OR BELOW LESS THAN 18":
- SLEEVE OR CENTER SEWER MAIN AND SLEEVE WATER MAIN OR CENTER AND RESTRAIN WATER MAIN

EXISTING SEWER MAIN ABOVE WATER MAIN, OR BELOW LESS THAN 18":

- POLYETHYLENE WRAP AND CONCRETE ENCASE SEWER MAIN JOINTS EXPOSED DURING TRENCH EXCAVATION AND SLEEVE WATER MAIN OR CENTER AND RESTRAIN WATER MAIN

EXISTING SEWER FORCE MAIN ABOVE WATER MAIN, OR BELOW LESS THAN 18":

- POLYETHYLENE WRAP AND CONCRETE ENCASE SEWER FORCE MAIN JOINTS WITHIN 10' EACH SIDE OF THE POINT OF CROSSING (UNLESS WELDED HDPE THEN NOT NECESSARY) AND SLEEVE WATER MAIN OR CENTER AND RESTRAIN WATER MAIN

<24" RCP STORM DRAIN ABOVE WATER MAIN, OR BELOW LESS THAN 18":

- POLYETHYLENE WRAP AND CONCRETE ENCASE RCP STORM DRAIN JOINTS WITHIN 10' EACH SIDE OF THE POINT OF CROSSING AND SLEEVE WATER MAIN OR CENTER AND RESTRAIN WATER MAIN
- USE EXTERNAL JOINT SEALANTS FOR RCP STORM DRAIN DIAMETERS FROM 16"-21" AND SLEEVE WATER MAIN OR CENTER AND RESTRAIN WATER MAIN

>OR=24" RCP STORM DRAIN ABOVE WATER MAIN, OR BELOW LESS THAN 18":

- POLYETHYLENE WRAP AND CONCRETE ENCASE RCP STORM DRAIN JOINTS WITHIN 10' EACH SIDE OF THE POINT OF CROSSING AND SLEEVE WATER MAIN OR CENTER AND RESTRAIN WATER MAIN
- USE EXTERNAL JOINT SEALANTS OR JOINT GASKETS ON RCP STORM DRAIN AND SLEEVE WATER MAIN OR CENTER AND RESTRAIN WATER MAIN
- 3USE EXTERNAL JOINT SEALANTS FOR RCP STORM DRAIN DIAMETERS FROM 24"-168" AND SLEEVE WATER MAIN OR CENTER AND RESTRAIN WATER MAIN

PVC STORM DRAIN ABOVE WATER MAIN, OR BELOW LESS THAN 18":

- SLEEVE OR CENTER PVC STORM DRAIN AND SLEEVE WATER MAIN OR CENTER AND RESTRAIN WATER MAIN

SEWER LATERAL ABOVE WATER MAIN, OR BELOW LESS THAN 12":

- SLEEVE WATER MAIN OR CENTER AND RESTRAIN WATER MAIN AND SLEEVE SEWER LATERAL
- SLEEVE WATER MAIN OR CENTER AND RESTRAIN WATER MAIN AND CENTER SEWER LATERAL

SEWER MAIN ABOVE WATER LATERAL, OR BELOW LESS THAN 18":

- USE PE TUBING CONFORMING TO AWWA STANDARD C901-88 AND ASTM D2737 FOR WATER LATERAL AND SLEEVE OR CENTER SEWER MAIN

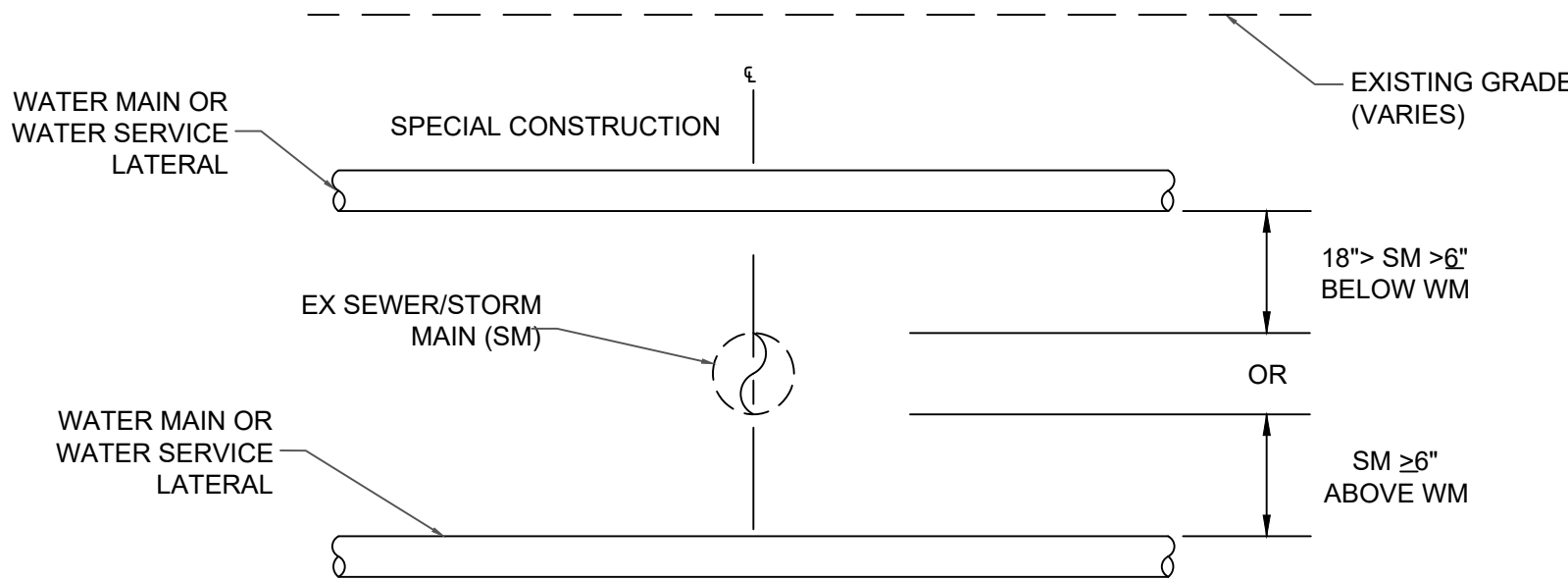

NOTES

- IF VERTICAL FITTINGS ARE USED TO ACHIEVE CROSSING, THEY ARE INCLUDED AS AN INCIDENTAL AND MUST BE FULLY RESTRAINED.
- IF WATER MAIN/WATER SERVICE LATERAL CROSSES OVER SEWER/STORM MAIN $\geq 18"$, NO SPECIAL CONSTRUCTION IS NEEDED.
- IF WATER MAIN/WATER SERVICE LATERAL CROSSES OVER SEWER/STORM MAIN $< 18"$ OR UNDER SEWER STORM MAIN:
 - ANY EXPOSED STORM DRAIN JOINTS AND SANITARY SEWER JOINTS SHALL BE WRAPPED IN POLYETHYLENE AND ENCASED IN CONCRETE. IF EXISTING SD OR SS MAIN IS SDR35, NO MITIGATION REQUIRED ON SD OR SS MAIN.
 - WATER MAIN MITIGATION TO INCLUDE RESTRAINED JOINTS, JOINTLESS PIPE, OR PIPE SLEEVE WITH WATER-TIGHT END SEALS.
- ALL WATER MAIN/WATER SERVICE LATERAL AND SEWER MAIN CROSSING SEPARATION SHALL COMPLY WITH NAC 445A.67165 AND 445A.6717
- REFER TO THE NDEP'S JUNE 2018 PUBLICATION TITLED "GUIDANCE FOR THE AREAS REQUIRING MITIGATION FOR WATER AND SEWER SEPARATION" FOR CIRCUMSTANCES NOT EXPLORED IN THIS SHEET.

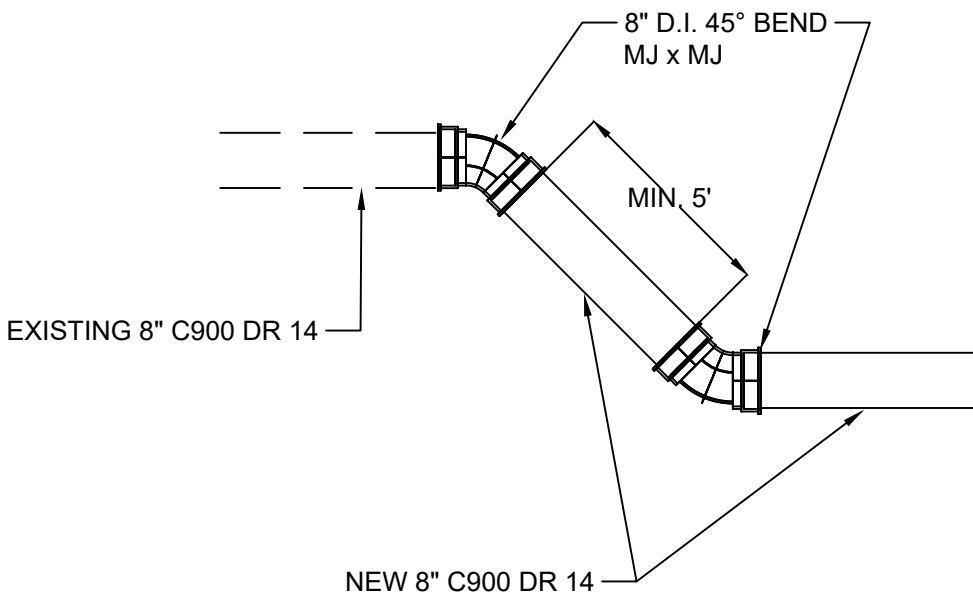

2 PONDEROSA STA. 1+00 CONNECTION DETAIL

D1.5 N.T.S

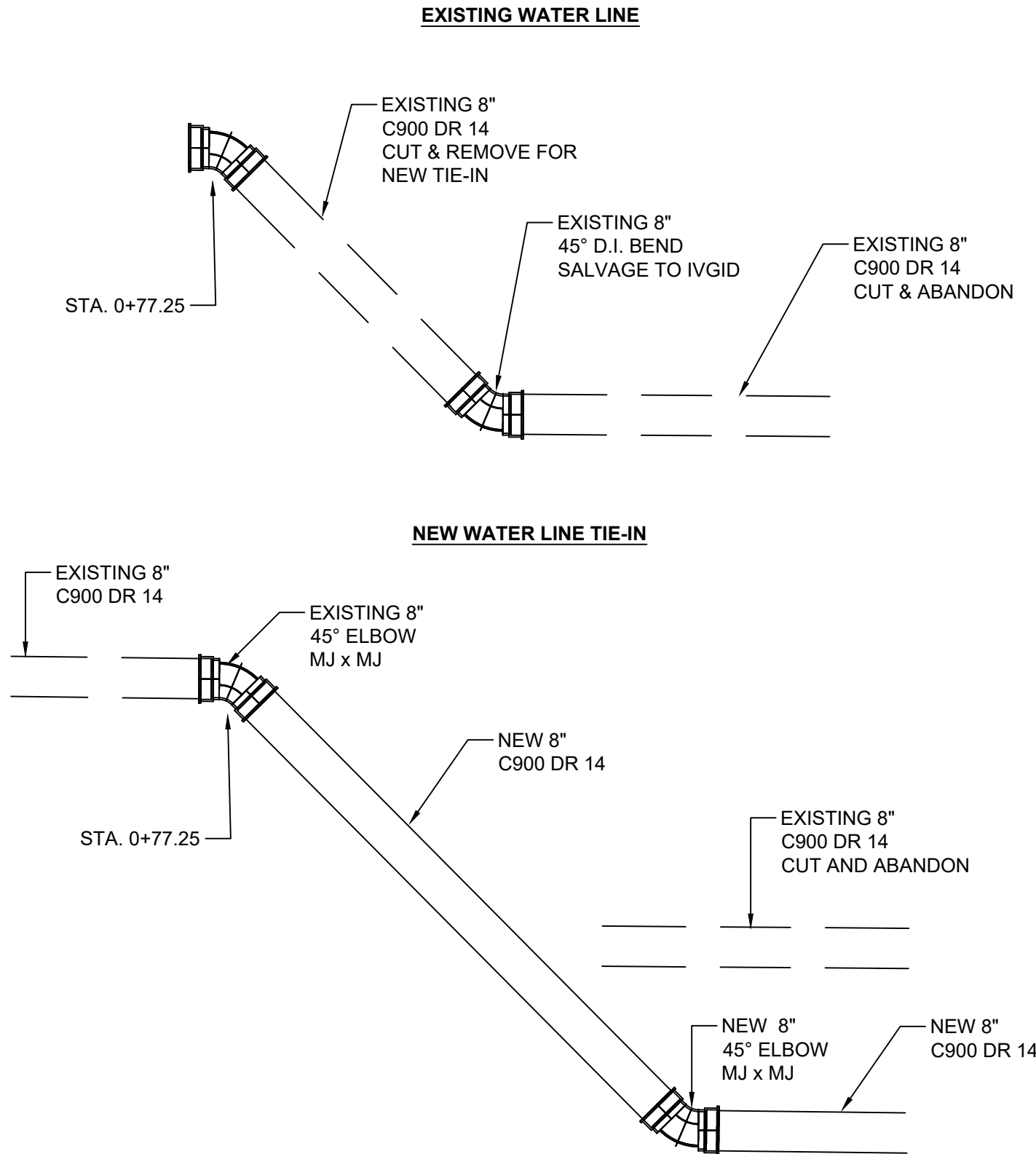

4 TUNNEL CR. STA. 0+77.25 CONNECTION DETAIL

D1.5 N.T.S

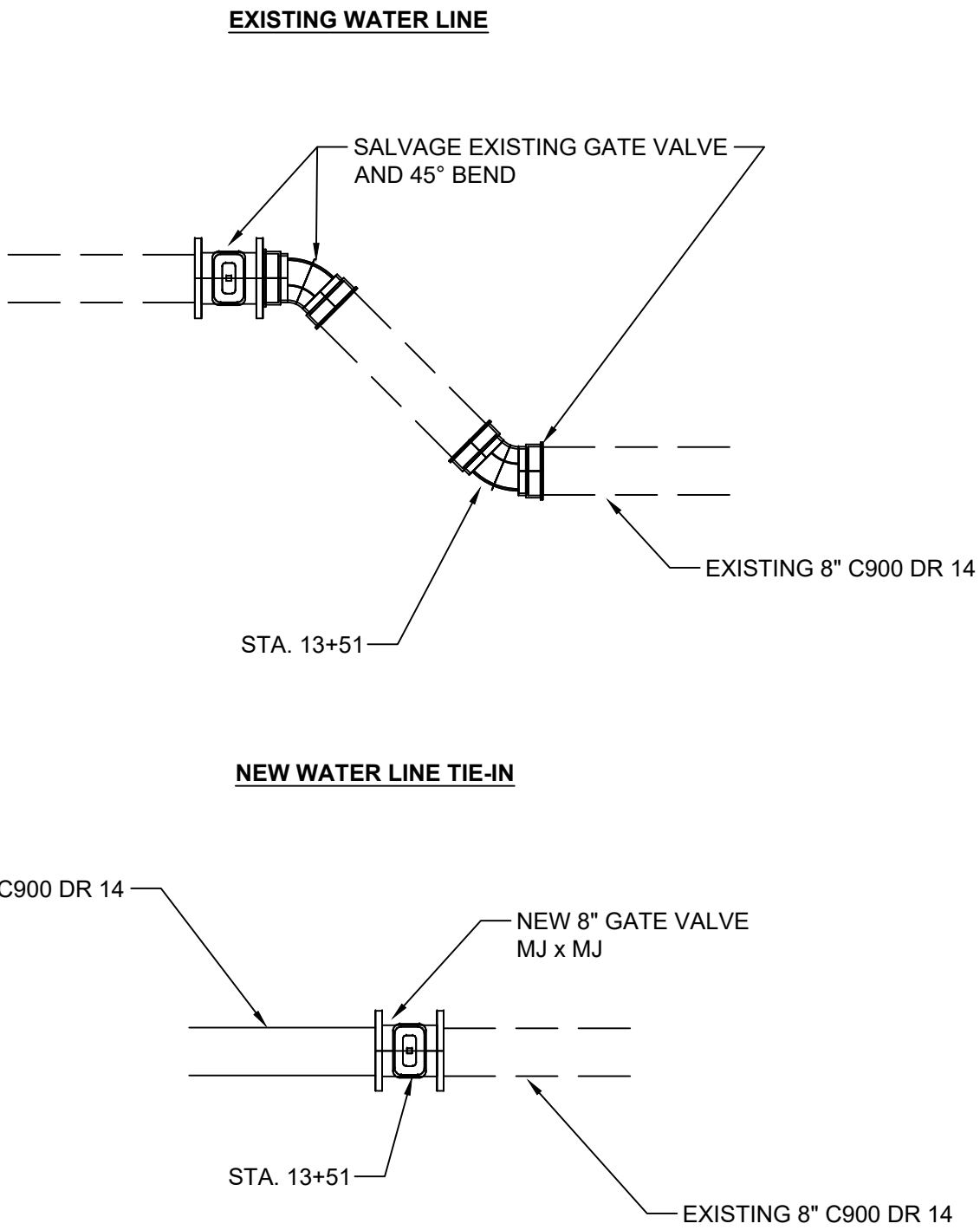

3 PONDEROSA STA. 13+51 CONNECTION DETAIL

D1.5 N.T.S

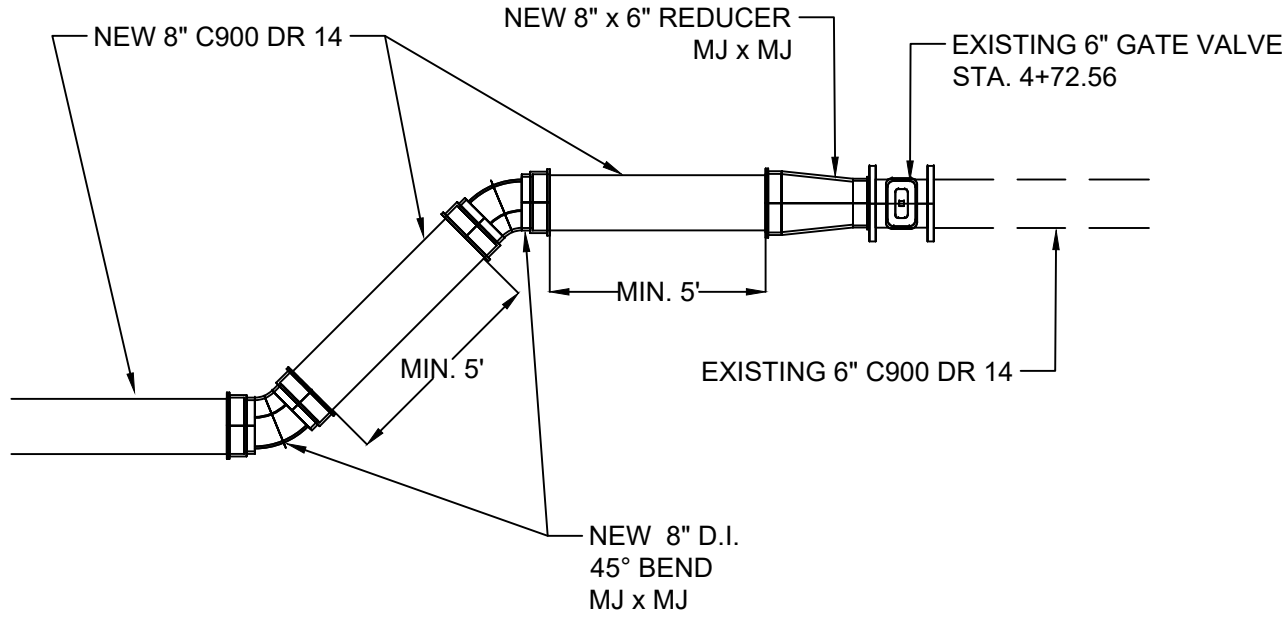

5 TUNNEL CR. STA. 4+72.56 CONNECTION DETAIL

D1.5 N.T.S

1 PIPE CROSSING DETAIL

D1.5 N.T.S